



SERVO-DRIVE for Drawers

Opening feature for MOVENTO,
TANDEM plus BLUMOTION, LEGRABOX,
MERIVOBX and TANDEMBOX

Opening has never been easier.

With a single touch or a light pull of the handle, drawers seem to open by themselves, then close again effortlessly with soft-close BLUMOTION. Experience SERVO-DRIVE, a low-voltage electrical opening feature for MOVENTO, TANDEM plus BLUMOTION, LEGRABOX, MERIVOBX and TANDEMBOX. No matter how heavy the drawer is, the opening action is light and smooth.





Contents

- 4 SERVO-DRIVE applications
- 6 Using the SERVO-DRIVE catalog
- 8 SERVO-DRIVE program overview
- 10 Planning
- 12 Vertical aluminum profile
- 20 Horizontal aluminum profile
- 28 Top bracket
- 36 Bottom bracket
- 44 SERVO-DRIVE uno
- 46 Power supply
- 50 Distance bumpers
- 51 Wiring options
- 52 Assembly/removal
- 56 Assembly aids
- 57 Accessories
- 58 Services
- 59 Part number index
- 62 moving ideas

SERVO-DRIVE applications





SPACE TOWER



SPACE TWIN



SPACE CORNER



SPACE STEP

Step 1

Determine application

Determine your SERVO-DRIVE installation method then proceed to the corresponding catalog page for specific information.

Applications

- Vertical aluminum profile for full height drawer stack
- Horizontal aluminum profile for single drawer applications
- Top bracket for top drawer applications
- Waste/recycle and bottom bracket sets for bottom drawer applications (waste/recycle and base pot and pan applications)

Step 2

Select parts

Choose the parts needed from the first two pages of each application.

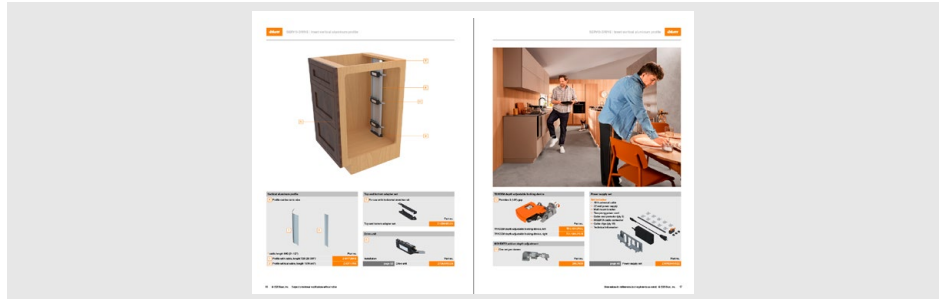

Step 3

Prepare cabinet

Refer to the boring location requirements chart to obtain the minimum inside cabinet depth and boring locations.

Using the location from the chart, pre-bore holes and install adapters or bracket.

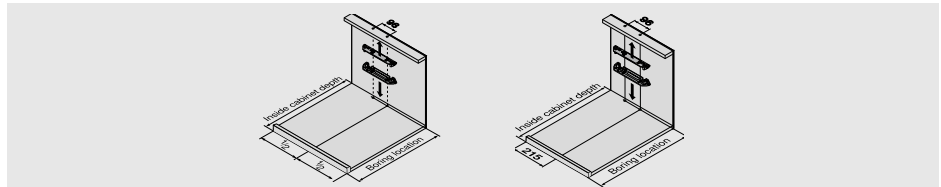

Boring location requirements

Drawer length	229 (9")	305 (12")	381 (15")	457 (18")	533 (21")	610 (24")	686 (27")	762 (30")
Boring location	253 (9-15/16")	329 (12-15/16")	405 (15-15/16")	481 (18-15/16")	557 (21-15/16")	634 (24-15/16")	710 (27-15/16")	786 (30-15/16")
Minimum inside cabinet depth	270 (10-5/8")	346 (13-5/8")	422 (16-5/8")	498 (19-5/8")	574 (22-5/8")	651 (25-5/8")	727 (28-5/8")	803 (31-5/8")

Step 4

Install profile

Install profile into adapters or bracket.

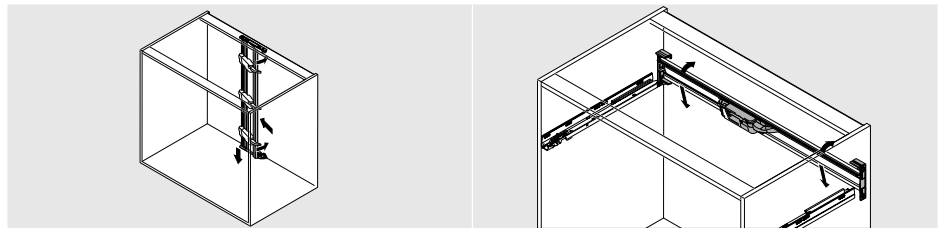

Step 5

Attach drive units

Attach the necessary number of drive units to the profile or bracket and ensure the arm contacts the center of the drawer back.

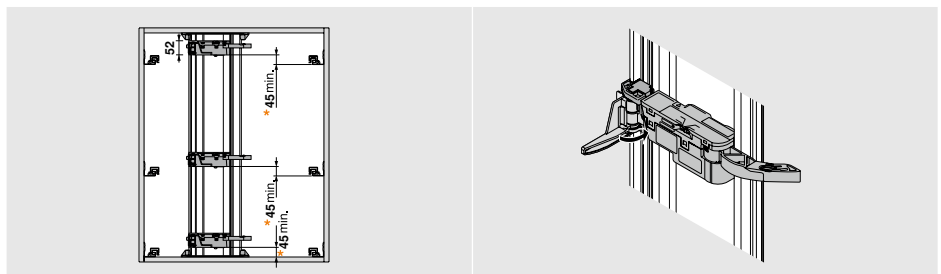

Step 6

Wire the cabinet

Connect necessary cable with INSERTA cable connectors and cap off with cable end protectors.

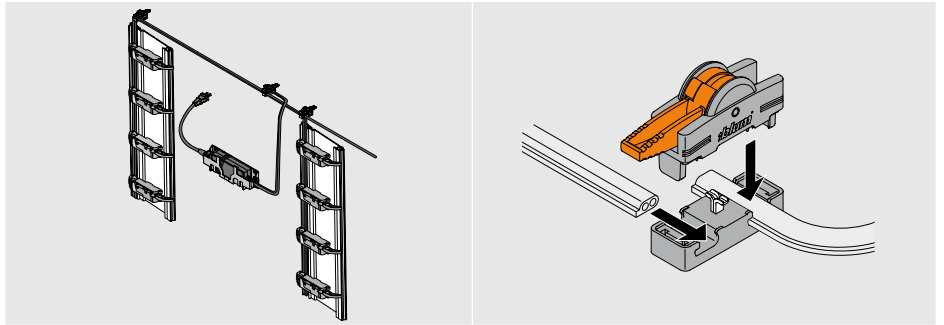

Step 7

Connect power supply

Attach wall mount bracket and insert power supply. Plug two-prong power cord into switched GFCI outlet.

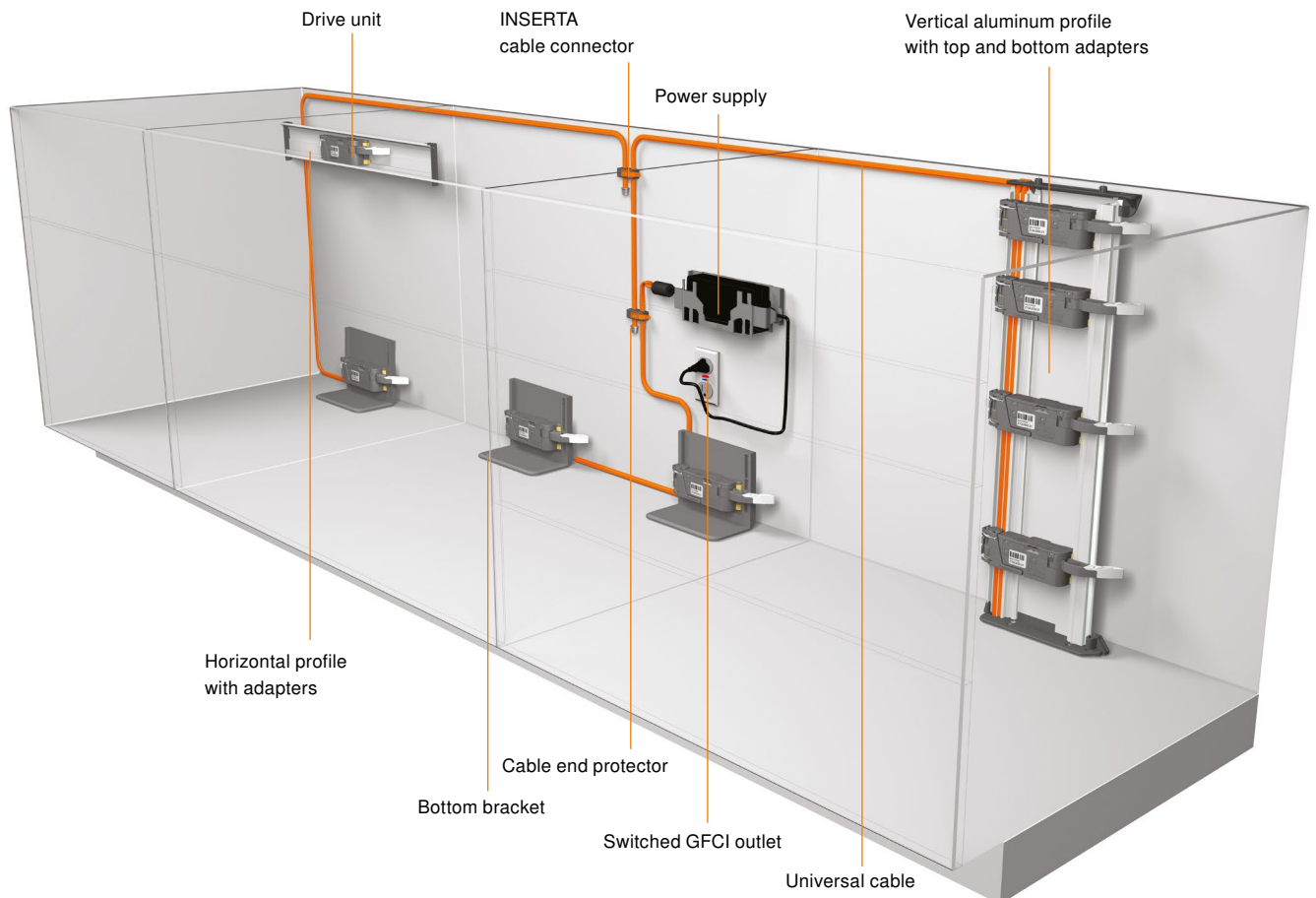
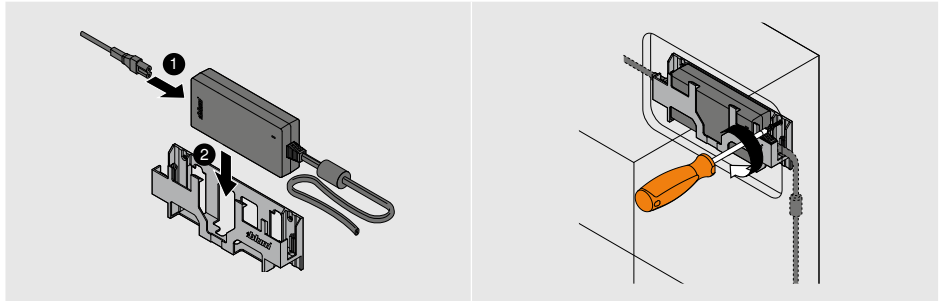

Vertical aluminum profile



Overlay drawer front

page 12



Inset drawer front

page 16

Horizontal aluminum profile



Overlay drawer front

page 20



Inset drawer front

page 24

Top bracket



Overlay drawer front

page 28



Inset drawer front

page 32

Bottom bracket



Overlay drawer front

page 36



Inset drawer front

page 40

SERVO-DRIVE uno



Waste/recycle set

page 44



Bottom bracket set

page 45

Power supply set



Wall mount power supply set

page 46



Plug-in power supply set

page 47

Plan with confidence

Plan your SERVO-DRIVE with the Product Configurator to ensure accuracy, efficiency and peace of mind. The tool guides you through every step, providing complete part lists, planning drawings and assembly details tailored to your design. With the results you get from a detailed configuration, we guarantee that you will be able to confidently install your SERVO-DRIVE application into your desired cabinet.



Use the Product Configurator to easily find the parts lists, CAD data and planning information for your SERVO-DRIVE configuration
www.blum.com/configurator



The EASY ASSEMBLY App makes assembling and installing Blum products easy. Created to be a helpful reference tool, this app uses up-to-date instruction sheets and videos to clearly show step-by-step directions for every product. Whether you are in the cabinet shop or on the jobsite, the EASY ASSEMBLY App is at your fingertips whenever you need it.



Download the EASY ASSEMBLY App for SERVO-DRIVE installation instructions and videos
www.blum.com

Your shortcut to smarter planning

When you're in the middle of a build, time matters. That's why we've tied our printed catalog to our online tools—so you can get the details you need quickly. From the catalog, you're just one step away from everything you need to plan, configure and order with confidence.

Here's the advantage:

Web codes take you straight from the product page in the catalog to the exact item in the Blum Product Configurator. No searching, no second-guessing. You'll have accurate planning info and a verified parts list ready to go—so you can keep your project moving.

Look for short URLs, QR codes, and web codes in the catalog. They'll link you to detailed digital resources like assembly and adjustment instructions, and application videos—everything you'd want before you start cutting or drilling.

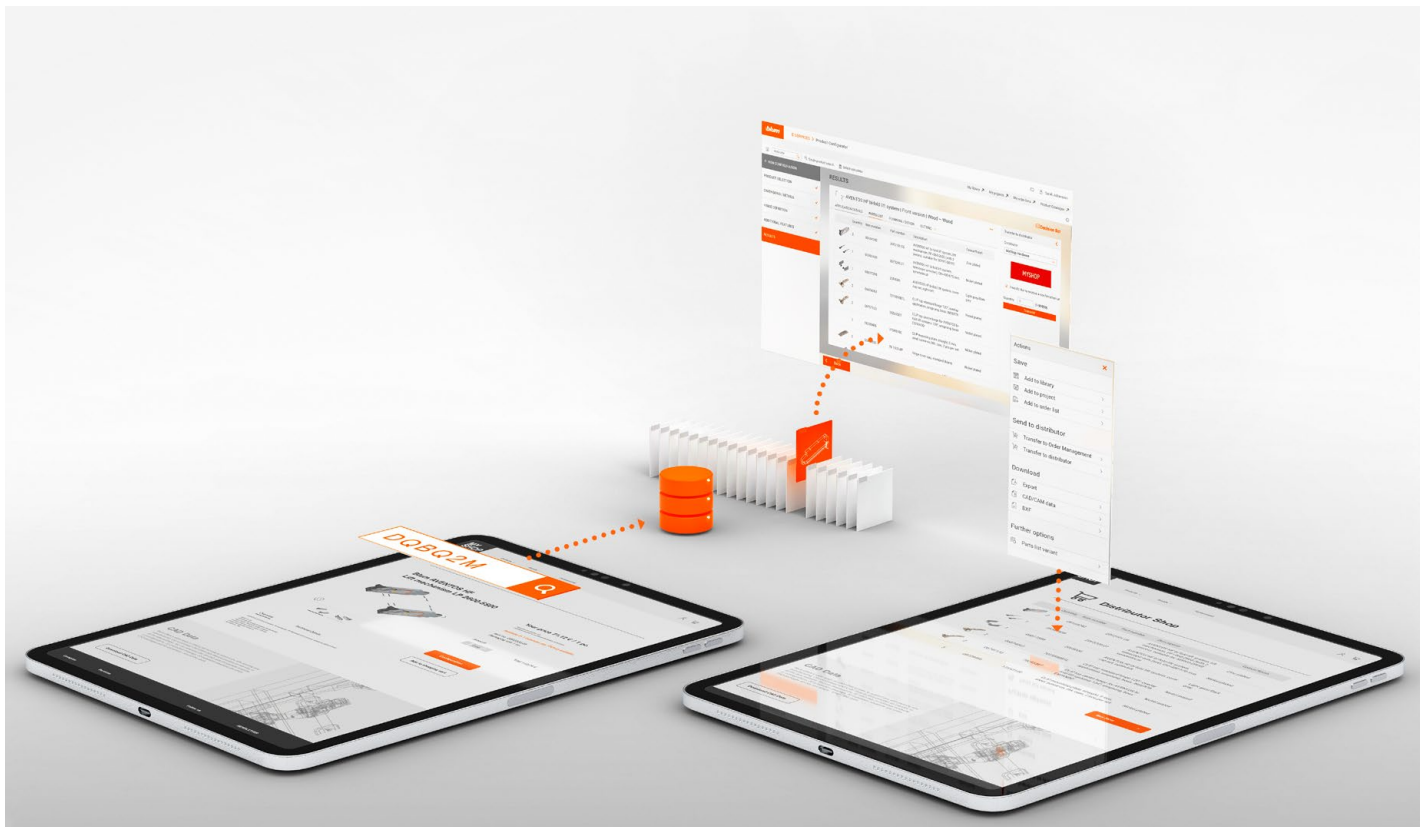

How to use web codes

1

Enter or click the code

Type the web code into the search bar on the Product Configurator homepage or click the code in the digital version of the catalog.

2

Configure your application

The web codes get you through the first few selections. From there, you can fine-tune the details and finish the configuration in just a few clicks.

3

Get your parts list

Once you're done, download the complete parts list or save it to My Library, My Projects, or My Order List—so everything's ready when you need it.



Web code – Click on the code or enter it in the Product Configurator

DQIGUM



Vertical aluminum profile

A Profile can be cut to size

*cable length **800** (31-1/2")

	Part no.
1 Profile with cable, length 720 (28-3/8")*	Z10T720AB
2 Profile without cable, length 1170 (46")	Z10T1170A

Top and bottom adapter set

B For use with horizontal stretcher rail

Part no.

Top and bottom adapter set	Z10D01E0.01
----------------------------	--------------------

Back and bottom adapter set

B For use with back stretcher rail

Part no.

Back and bottom adapter set with cover cap	Z10D01EA.01
--	--------------------



Drive unit

C



Installation Part no.

page 53	Drive unit	Z10A3000.04
---------	------------	-------------

Blum distance bumper

D Provides 3 (1/8") gap



Part no.

Installation	1	Ø5 bumper	993.0531
page 50	2	Screw-on bumper	993.1220

Power supply set

Set includes:

- 19 ft universal cable
- 72 watt power supply
- Wall mount bracket
- Two-prong power cord
- Cable end protector (qty 3)
- INSERTA cable connector
- Cable clips (qty 10)
- Technical information

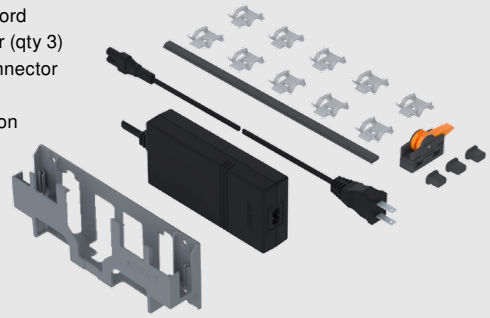

Part no.

page 46	Power supply set	Z10NE04UG22
---------	------------------	-------------

Specifications

For the most up-to-date planning information, refer to the Product Configurator for your specific application.

Space requirements for top and bottom adapter



Web code – SERVO-DRIVE

DQIGUM

For opening widths **430** (16-15/16") and wider

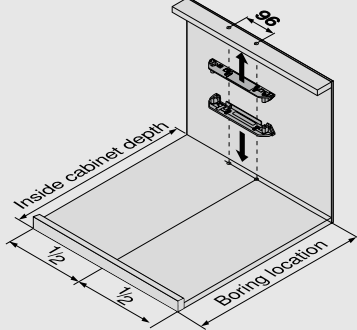

For opening widths **305 to 430** (12"–16-15/16")

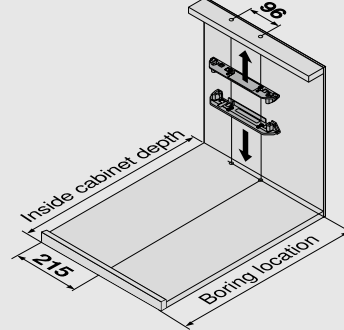

Boring location requirements for MOVENTO and TANDEM plus BLUMOTION



Web code – MOVENTO / TANDEM plus BLUMOTION

DQIBXA

Drawer length	229 (9")	305 (12")	381 (15")	457 (18")	533 (21")	610 (24")	686 (27")	762 (30")
Boring location	253 (9-15/16")	329 (12-15/16")	405 (15-15/16")	481 (18-15/16")	557 (21-15/16")	634 (24-15/16")	710 (27-15/16")	786 (30-15/16")
Min. inside cabinet depth	270 (10-5/8")	346 (13-5/8")	422 (16-5/8")	498 (19-5/8")	574 (22-5/8")	651 (25-5/8")	727 (28-5/8")	803 (31-5/8")

Boring location requirements for LEGRABOX, MERIVOBX and TANDEMBOX



Web code – LEGRABOX / MERIVOBX / TANDEMBOX

DQIB7Y

Actual cabinet profile length	270 (10-5/8")	350 (13-3/4")	400 (15-3/4")	450 (17-11/16")	500 (19-11/16")	550 (21-5/8")	600 (23-5/8")	650 (25-9/16")
Boring location	289 (11-3/8")	369 (14-1/2")	419 (16-1/2")	469 (18-7/16")	519 (20-7/16")	569 (22-3/8")	619 (24-3/8")	669 (26-5/16")
Min. inside cabinet depth	306 (12-1/16")	386 (15-3/16")	436 (17-3/16")	486 (19-1/8")	536 (21-1/8")	586 (23-1/16")	636 (25-1/16")	686 (27")

NOTE: 41 (1-5/8") is required between drawer back and back panel

Boring specifications

Top and bottom boring pattern

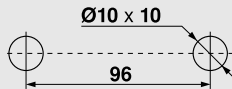

Calculating vertical profile length

Profile length = inside cabinet height minus 19 (3/4")

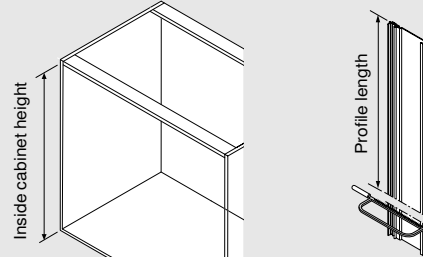

Installing vertical aluminum profile

- 1 Set profile onto bottom adapter
- 2 Push profile toward left side while engaging top
- 3 Push back on right side and snap into place

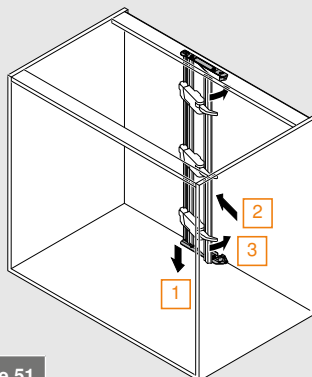

Wiring options

page 51

Positioning the drive unit

Lever arm should contact center of drawer back

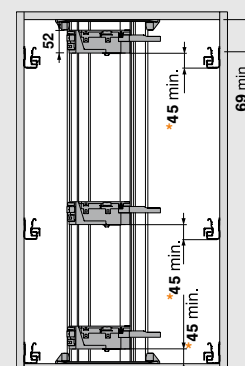

*For most standard applications. May have to be raised in some narrow applications.

Space requirements for back and bottom adapter



Web code – SERVO-DRIVE

DQIGUM

For opening widths **430** (16-15/16") and wider

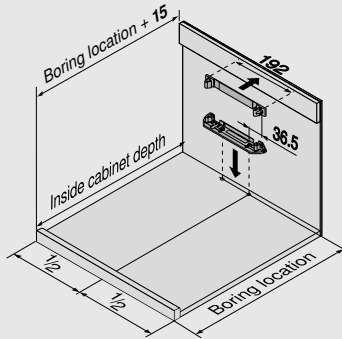

For opening widths **305 to 430** (12" – 16-15/16")

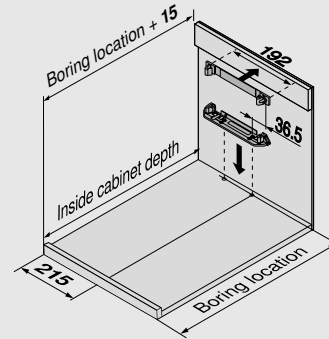

Boring location requirements for MOVENTO and TANDEM plus BLUMOTION



Web code – MOVENTO / TANDEM plus BLUMOTION

DQIBXA

Drawer length	229 (9")	305 (12")	381 (15")	457 (18")	533 (21")	610 (24")	686 (27")	762 (30")
Boring location	253 (9-15/16")	329 (12-15/16")	405 (15-15/16")	481 (18-15/16")	557 (21-15/16")	634 (24-15/16")	710 (27-15/16")	786 (30-15/16")
Min. inside cabinet depth	270 (10-5/8")	346 (13-5/8")	422 (16-5/8")	498 (19-5/8")	574 (22-5/8")	651 (25-5/8")	727 (28-5/8")	803 (31-5/8")

Boring location requirements for LEGRABOX, MERIVOBX and TANDEMBOX



Web code – LEGRABOX / MERIVOBX / TANDEMBOX

DQIB7Y

Actual cabinet profile length	270 (10-5/8")	350 (13-3/4")	400 (15-3/4")	450 (17-11/16")	500 (19-11/16")	550 (21-5/8")	600 (23-5/8")	650 (25-9/16")
Boring location	289 (11-3/8")	369 (14-1/2")	419 (16-1/2")	469 (18-7/16")	519 (20-7/16")	569 (22-3/8")	619 (24-3/8")	669 (26-5/16")
Min. inside cabinet depth	306 (12-1/16")	386 (15-3/16")	436 (17-3/16")	486 (19-1/8")	536 (21-1/8")	586 (23-1/16")	636 (25-1/16")	686 (27")

NOTE: 41 (1-5/8") is required between drawer back and back panel

Boring specifications

Back screw positioning

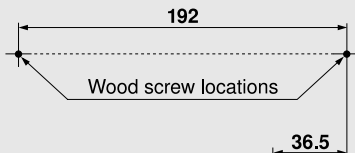

Bottom boring pattern

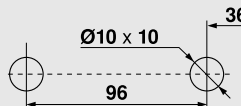

Determining vertical profile length

Profile length is dependent upon back adapter location.

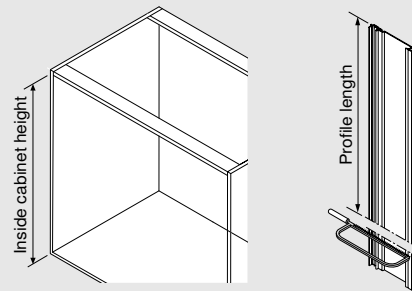

Installing vertical aluminum profile

- 1 Set profile onto bottom adapter
- 2 Push profile toward back while engaging adapter
- 3 Snap cover cap onto top of profile



Wiring options

page 51

Positioning the drive unit

Lever arm should contact center of drawer back

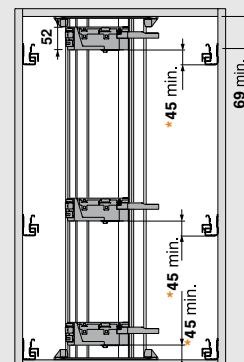

*For most standard applications. May have to be raised in some narrow applications.



Vertical aluminum profile

A Profile can be cut to size

*cable length **800** (31-1/2")

	Part no.
1 Profile with cable, length 720 (28-3/8")*	Z10T720AB
2 Profile without cable, length 1170 (46")	Z10T1170A

Top and bottom adapter set

B For use with horizontal stretcher rail

Part no.

Top and bottom adapter set	Z10D01E0.01
----------------------------	--------------------

Drive unit

C

Part no.

Installation	page 53	Drive unit	Z10A3000.04
--------------	---------	------------	--------------------



TANDEM depth adjustable locking device

D Provides 3 (1/8") gap

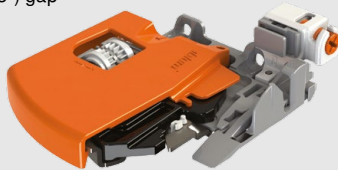

Part no.

TANDEM depth adjustable locking device, left

T51.1901.PS L

TANDEM depth adjustable locking device, right

T51.1901.PS R

MOVENTO add-on depth adjustment

D One set per drawer



Part no.

298.7600

Power supply set

Set includes:

- 19 ft universal cable
- 72 watt power supply
- Wall mount bracket
- Two-prong power cord
- Cable end protector (qty 3)
- INSERTA cable connector
- Cable clips (qty 10)
- Technical information

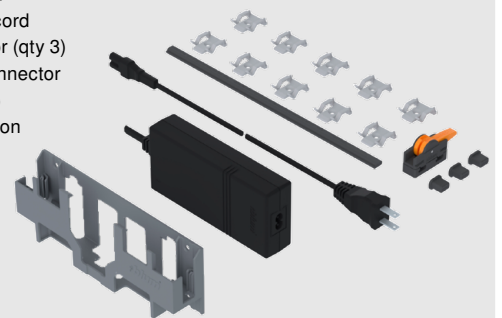

Part no.

Z10NE04UG22

Specifications

Space requirements

For opening widths **430** (16-15/16") and wider

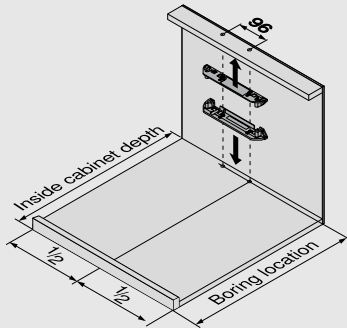

For opening widths **305 to 430** (12" – 16-15/16")

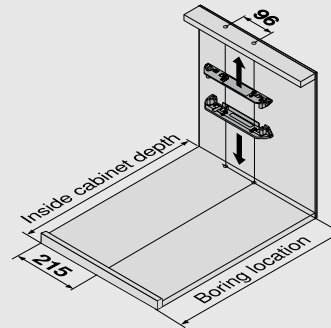

Boring specifications

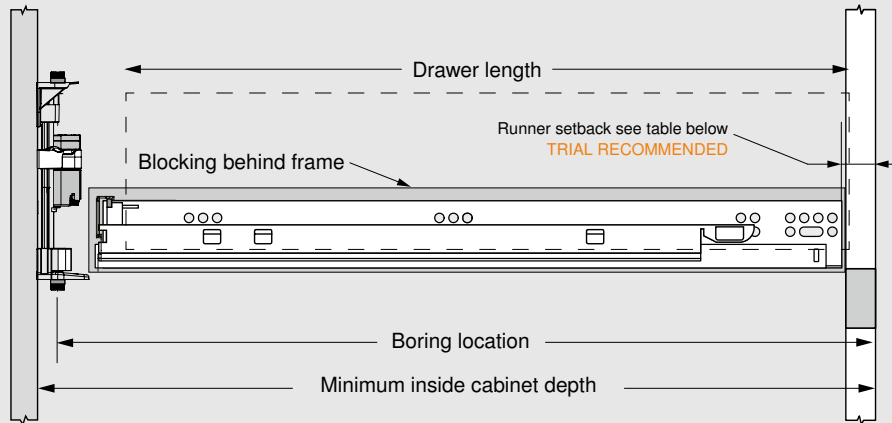

Boring location requirements

Boring location = drawer length + **21** (13/16") + runner setback

Minimum inside cabinet depth = drawer length + **41** (1-5/8") + runner setback

Calculating runner setback

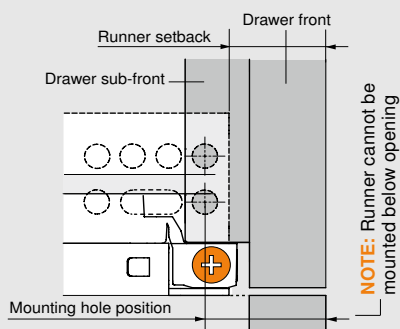

TANDEM plus BLUMOTION

563 H/. (sub-front thickness + drawer front thickness minus **9** (11/32") = runner setback)

563 F (sub-front thickness + drawer front thickness minus **12** (15/32") = runner setback)

- These setbacks recess the face of the drawer front inside of the cabinet **1** (1/32")
- The depth adjustment can then be used to move the drawer front out to its desired position, **2.5** (3/32") out adjustment only

MOVENTO

763H/. and 769. (sub-front thickness + drawer front thickness minus **9.5** (3/8") = runner setback)

769R (sub-front thickness + drawer front thickness + **5** (3/16") = runner setback)

- These setbacks recess the face of the drawer front inside of the cabinet **0.5** (1/32")
- The depth adjustment can then be used to move the drawer front in or out to its desired position **±2** (3/32")

NOTE: For mounting hole position, add **7** (9/32") to runner setback

Boring specifications

Top and bottom boring pattern

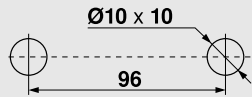

Calculating vertical profile length

Profile length = inside cabinet height minus 19 (3/4")

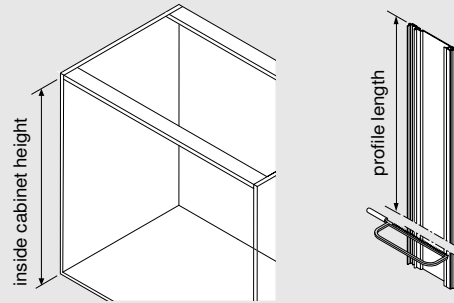

Installing vertical aluminum profile

- 1 Set profile onto bottom adapter
- 2 Push profile toward left side while engaging top
- 3 Push back on right side and snap into place

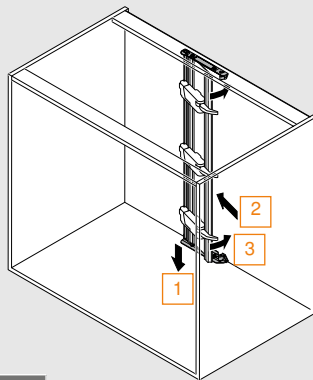

Wiring options

page 51

Positioning the drive unit

Lever arm should contact center of drawer back

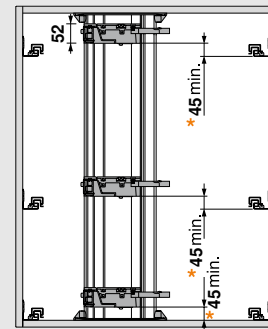

*For most standard applications. May have to be raised in some narrow applications.

TANDEM depth adjustable locking device



Installation

page 54

- Ideal for inset applications and any SERVO-DRIVE application
- Captive right device and self-aligning left device
- Self-adjusting drawer length tolerance
- Steel base with synthetic, spring-loaded release levers
- Minimum inside drawer width 170 (6-11/16")
- Height adjustment +3 (1/8")
- Side-to-side adjustment ±1.5 (1/16")
- Depth adjustment +2.5 (3/32"), preset at 0
- Minimum sub-front thickness 13 (1/2")
- Designed for 13 (1/2") drawer bottom recess
- Integrated 3 (1/8") distance bumper for inset or overlay SERVO-DRIVE applications

MOVENTO add-on depth adjustment



- Depth adjustment ±2 (3/32"), preset at 0
- Integrated 3 (1/8") distance bumper for inset or overlay SERVO-DRIVE applications
- One set per drawer



Horizontal aluminum profile

A



Part no.

Profile length **1143** (45"), cut to size

Z10T1143B

Adapter set for horizontal aluminum profile

Set includes:

- Panel adapters (left and right)
- Profile adapter
- Installation template

B



C



Part no.

Adapter set for horizontal profile

Z10D5210.US

Installation wood screw

606N or 606P

Installation system screw

661.1300.HG



Drive unit

D



Installation

Part no.

page 53

Drive unit

Z10A3000.04

Blum distance bumper

E Provides 3 (1/8") gap

1



2



Part no.

Installation

1 Ø5 bumper

993.0531

page 50

2 Screw-on bumper

993.1220

Power supply set

Set includes:

- 19 ft universal cable
- 72 watt power supply
- Wall mount bracket
- Two-prong power cord
- Cable end protector (qty 3)
- INSERTA cable connector
- Cable clips (qty 10)
- Technical information

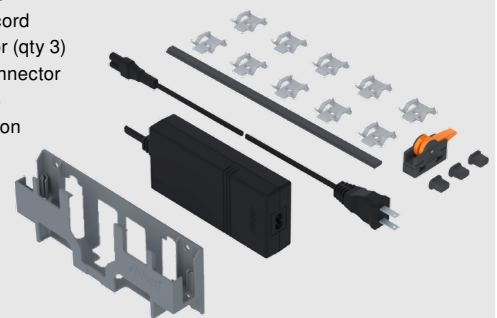

Part no.

page 46

Power supply set

Z10NE04UG22

Specifications

For the most up-to-date planning information, refer to the Product Configurator for your specific application.

Space requirements



Web code – SERVO-DRIVE

DQIGUM

Concealed runners

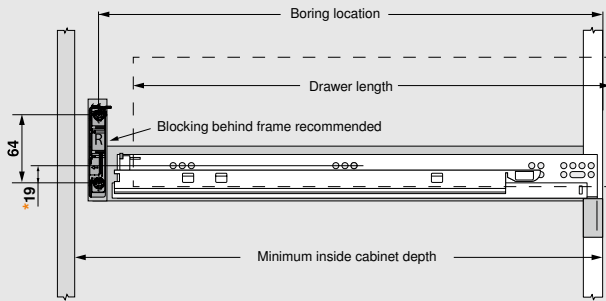

Box systems

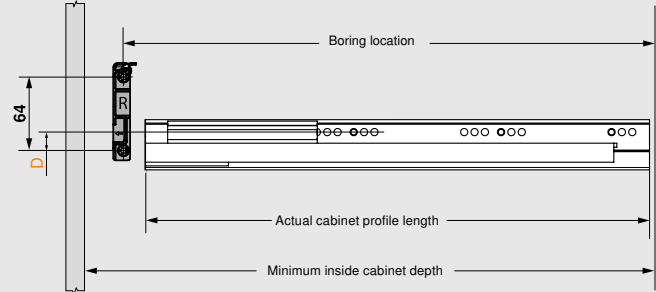

	D
LEGRABOX	12
MERIVOBX	30
TANDEMBOX	16

*For most standard applications. May have to be raised in some narrow applications.

Boring location requirements for MOVENTO and TANDEM plus BLUMOTION



Web code – MOVENTO / TANDEM plus BLUMOTION

DQIBXA

Drawer length	305 (12")	381 (15")	457 (18")	533 (21")	610 (24")	686 (27")	762 (30")
Boring Location	337 (13-1/4")	413 (16-1/4")	489 (19-1/4")	565 (22-1/4")	642 (25-1/4")	718 (28-1/4")	794 (31-1/4")
Min. inside cabinet depth	346 (13-5/8")	422 (16-5/8")	498 (19-5/8")	574 (22-5/8")	651 (25-5/8")	727 (28-5/8")	803 (31-5/8")

Boring location requirements for LEGRABOX, MERIVOBX and TANDEMBOX



Web code – LEGRABOX / MERIVOBX / TANDEMBOX

DQIB7Y

Actual cabinet profile length	270 (10-5/8")	350 (13-3/4")	400 (15-3/4")	450 (17-11/16")	500 (19-11/16")	550 (21-5/8")	600 (23-5/8")	650 (25-9/16")
Boring location	297 (11-11/16")	377 (14-13/16")	427 (16-13/16")	477 (18-3/4")	527 (20-3/4")	577 (22-11/16")	627 (24-11/16")	677 (26-5/8")
Min. inside cabinet depth	306 (12-1/16")	386 (15-3/16")	436 (17-3/16")	486 (19-1/8")	536 (21-1/8")	586 (23-1/16")	636 (25-1/16")	686 (27")

NOTE: 41 (1-5/8") is required between drawer back and back panel. Minimum opening width is 305 (12")

Mounting of adapters

- 1 Set cardboard template onto runner or measure and mark hole dimensions using tables above
- 2 Punch and pre-bore hole locations

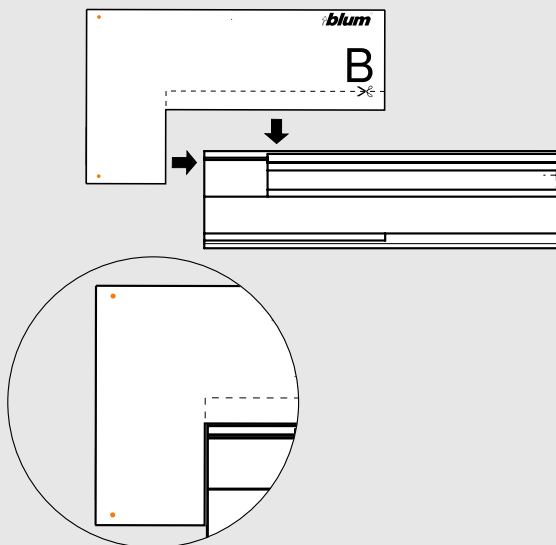

- 3 Attach panel adapters using four wood screws (606N or 606P) or four system screws (661.1300.HG)

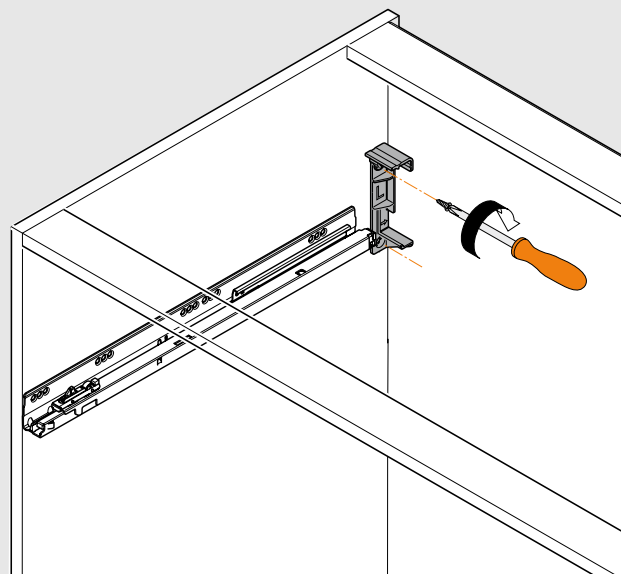

NOTE: Template is for frameless or blocked-out face frame only

Calculating horizontal profile size

Profile length = interior cabinet opening minus 19 (3/4")

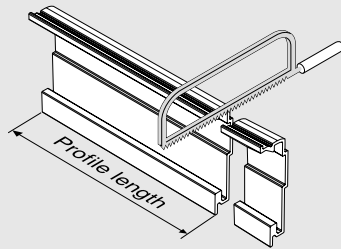

Installing profile adapter onto horizontal profile

1 Place bottom of profile adapter into the bottom slot of profile

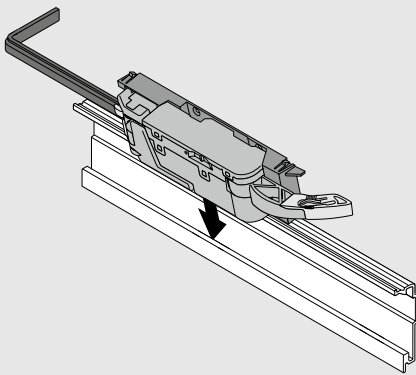

2 Push top of profile adapter toward the back of the profile and snap into place

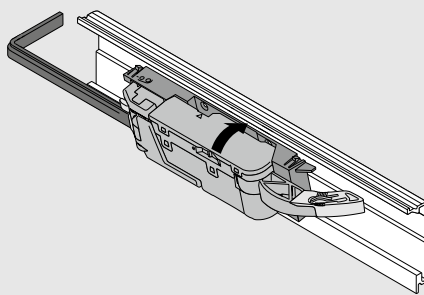

3 Align cable along bottom slot of profile

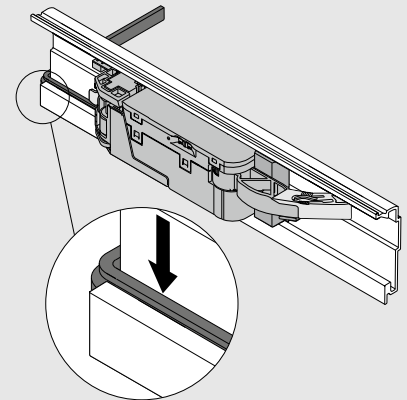

Installing horizontal profile into adapters

- 1 Slide cable through the notch in the adapter
- 2 Push horizontal profile toward bottom
- 3 Slide profile toward left adapter
- 4 Push top of profile to snap into adapter

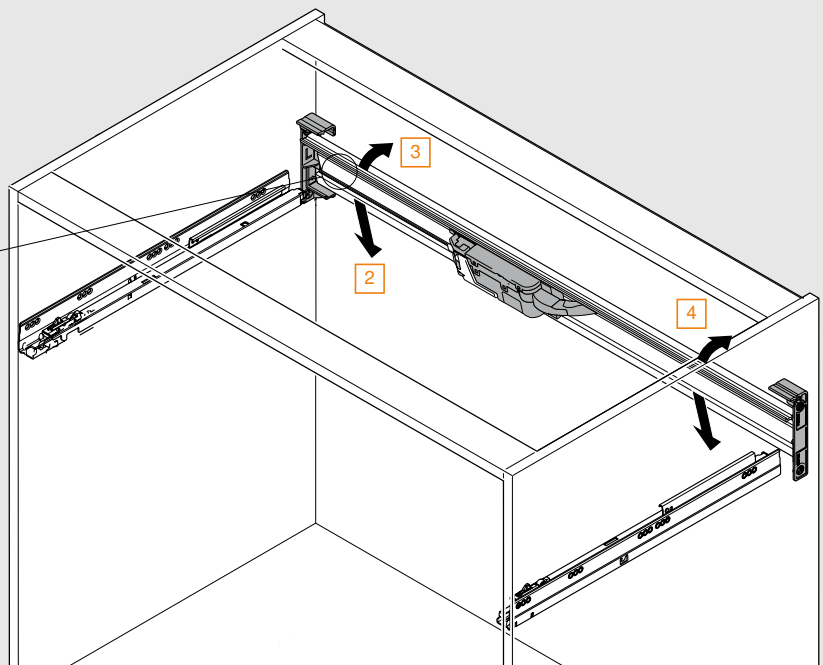
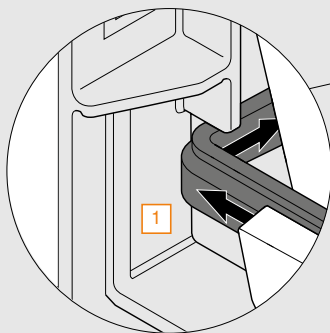

Wiring options



Horizontal aluminum profile

A



Part no.

Profile length **1143** (45"), cut to size

Z10T1143B

Adapter set for horizontal aluminum profile

Set includes:

- Panel adapters (left and right)
- Profile adapter
- Installation template

B C



Part no.

Adapter set for horizontal profile	Z10D5210.US
Installation wood screw	606N or 606P
Installation system screw	661.1300.HG



Drive unit

D



Installation Part no.

page 53	Drive unit	Z10A3000.04
---------	------------	-------------

MOVENTO add-on depth adjustment

E One set per drawer



Part no.

	298.7600
--	----------

TANDEM depth adjustable locking device

E Provides 3 (1/8") gap



Part no.

TANDEM depth adjustable locking device, left	T51.1901.PS L
TANDEM depth adjustable locking device, right	T51.1901.PS R

Power supply set

Set includes:

- 19 ft universal cable
- 72 watt power supply
- Wall mount bracket
- Two-prong power cord
- Cable end protector (qty 3)
- INSERTA cable connector
- Cable clips (qty 10)
- Technical information

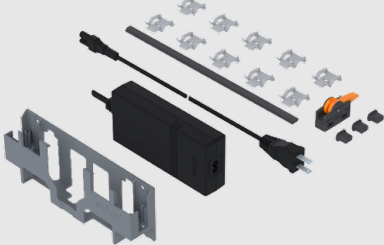

Part no.

page 46	Power supply set	Z10NE04UG22
---------	------------------	-------------

Specifications

Space requirements

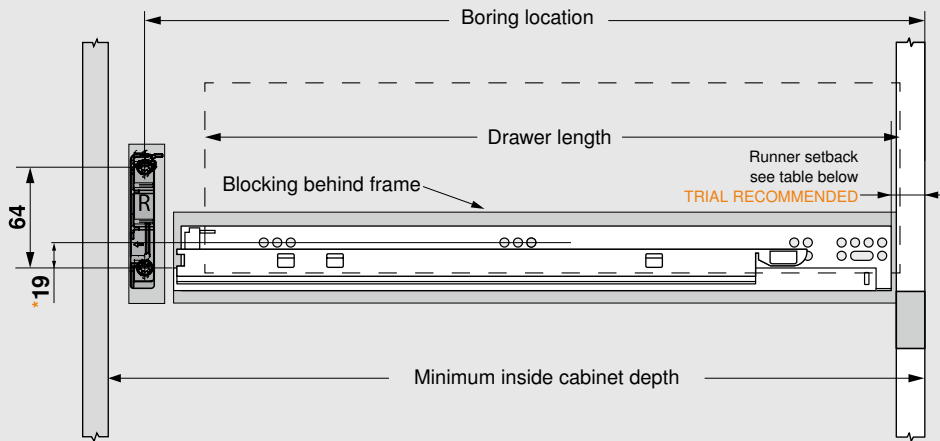

*For most standard applications. May have to be raised in some narrow applications.

Cabinet depth requirements

Boring location = drawer length + 29 (1-1/8") + runner setback

Minimum inside cabinet depth = drawer length + 41 (1-5/8") + runner setback

Calculating runner setback

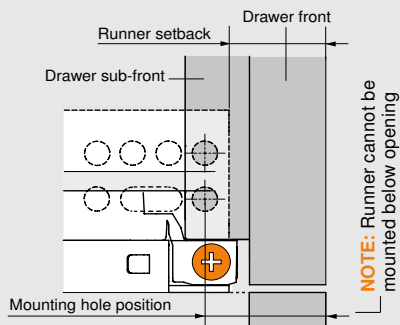

TANDEM plus BLUMOTION

563 H/. (sub-front thickness + drawer front thickness minus 9 (11/32") = runner setback)

563 F (sub-front thickness + drawer front thickness minus 12 (15/32") = runner setback)

- These setbacks recess the face of the drawer front inside of the cabinet 1 (1/32")
- The depth adjustment can then be used to move the drawer front out to its desired position, 2.5 (3/32") out adjustment only

MOVENTO

763H/. and 769. (sub-front thickness + drawer front thickness minus 9.5 (3/8") = runner setback)

769R (sub-front thickness + drawer front thickness + 5 (3/16") = runner setback)

- These setbacks recess the face of the drawer front inside of the cabinet 0.5 (1/32")
- The depth adjustment can then be used to move the drawer front in or out to its desired position ±2 (3/32")

NOTE: For mounting hole position, add 7 (9/32") to runner setback

TANDEM depth adjustable locking device



- Ideal for inset applications and any SERVO-DRIVE application
- Captive right device and self-aligning left device
- Self-adjusting drawer length tolerance
- Steel base with synthetic, spring-loaded release levers
- Minimum inside drawer width 170 (6-11/16")
- Height adjustment +3 (1/8")
- Side-to-side adjustment ±1.5 (1/16")
- Depth adjustment +2.5 (3/32"), preset at 0
- Minimum sub-front thickness 13 (1/2")
- Designed for 13 (1/2") drawer bottom recess
- Integrated 3 (1/8") distance bumper for inset or overlay SERVO-DRIVE applications

Installation

page 54

MOVENTO add-on depth adjustment



- Depth adjustment ±2 (3/32"), preset at 0
- Integrated 3 (1/8") distance bumper for inset or overlay SERVO-DRIVE applications
- One set per drawer

Calculating horizontal profile size

Profile length = interior cabinet opening minus 19 (3/4")

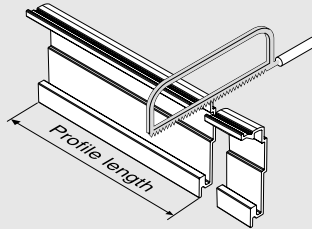

Installing profile adapter onto horizontal profile

1 Place bottom of profile adapter into the bottom slot of profile

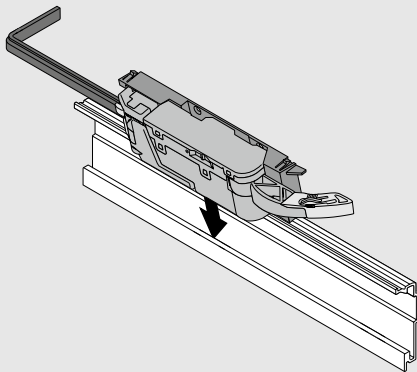

2 Push top of profile adapter toward the back of the profile and snap into place

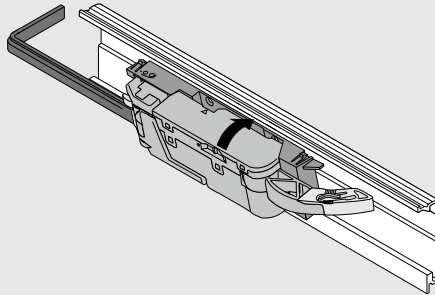

3 Align cable along bottom slot of profile

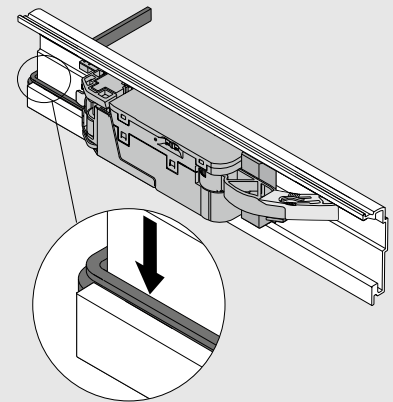

Installing horizontal profile into adapters

- 1 Slide cable through the notch in the adapter
- 2 Push horizontal profile toward bottom
- 3 Slide profile toward left adapter
- 4 Push top of profile to snap into adapter

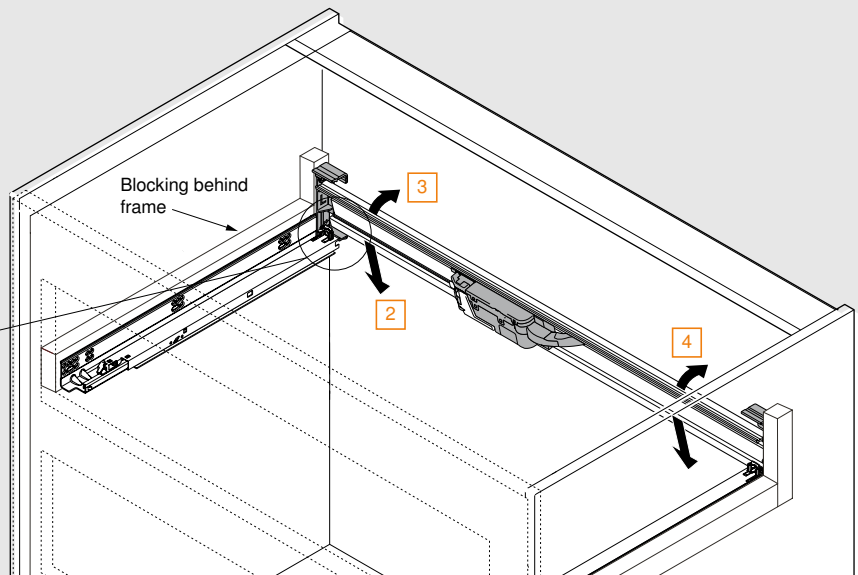
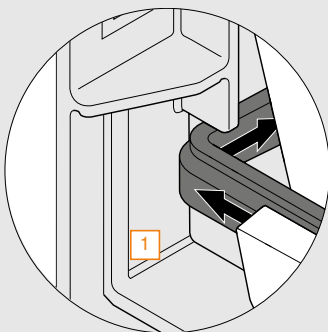

Wiring options



Top bracket with adapter

A

Part no.

Top bracket with adapter	Z10D6252
Installation screw	661.1300.HG

Drive unit

B

Installation

page 53	Drive unit	Part no.
		Z10A3000.04

Blum distance bumper

C Provides 3 (1/8") gap

Part no.

Installation	1 Ø5 bumper	993.0531
page 50	2 Screw-on bumper	993.1220



Power supply set

Set includes:

- 19 ft universal cable
- 72 watt power supply
- Wall mount bracket
- Two-prong power cord
- Cable end protector (qty 3)
- INSERTA cable connector
- Cable clips (qty 10)
- Technical information

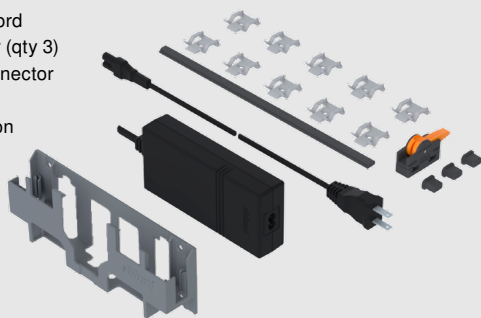

Part no.

Specifications

For the most up-to-date planning information, refer to the Product Configurator for your specific application.

Space requirements Web code – SERVO-DRIVE **DQIGUM**

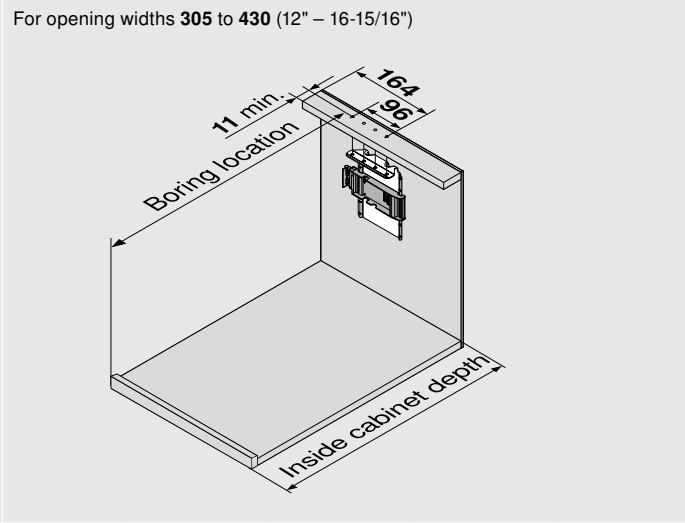
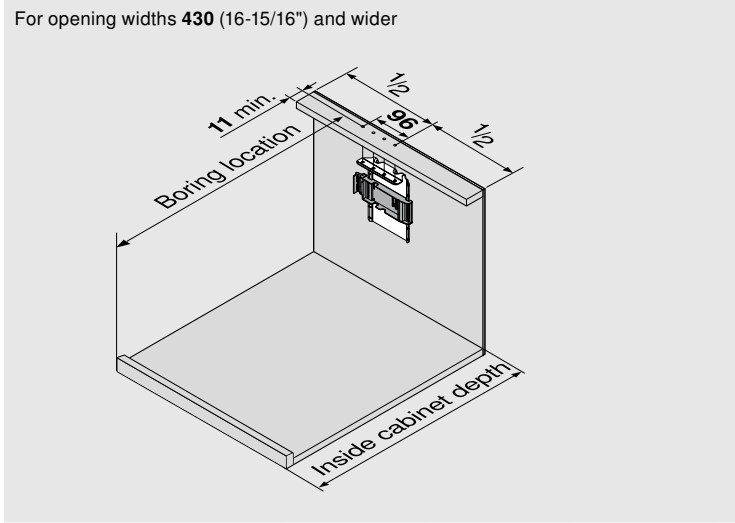

Boring location requirements for MOVENTO and TANDEM plus BLUMOTION Web code – MOVENTO / TANDEM plus BLUMOTION **DQIBXA**

Drawer length	229 (9")	305 (12")	381 (15")	457 (18")	533 (21")	610 (24")	686 (27")	762 (30")
Boring location	233 (9-3/16")	309 (12-3/16")	385 (15-3/16")	461 (18-1/8")	537 (21-1/8")	614 (24-3/16")	690 (27-3/16")	766 (30-3/16")
Min. inside cabinet depth	270 (10-5/8")	346 (13-5/8")	422 (16-5/8")	498 (19-5/8")	574 (22-5/8")	651 (25-5/8")	727 (28-5/8")	803 (31-5/8")

Boring location requirements for LEGRABOX, MERIVOBX and TANDEMBOX Web code – LEGRABOX / MERIVOBX / TANDEMBOX **DQIB7Y**

Actual Cabinet Profile Length	270 (10-5/8")	350 (13-3/4")	400 (15-3/4")	450 (17-11/16")	500 (19-11/16")	550 (21-5/8")	600 (23-5/8")	650 (25-9/16")
Boring location	269 (10-9/16")	349 (13-3/4")	399 (15-11/16")	449 (17-11/16")	499 (19-5/8")	549 (21-5/8")	599 (23-9/16")	649 (25-9/16")
Min. inside cabinet depth	306 (12-1/16")	386 (15-3/16")	436 (17-3/16")	486 (19-1/8")	533 (21-1/8")	586 (23-1/16")	636 (25-1/16")	686 (27")

NOTE: 41 (1-5/8") is required between drawer back and back panel

Boring specifications

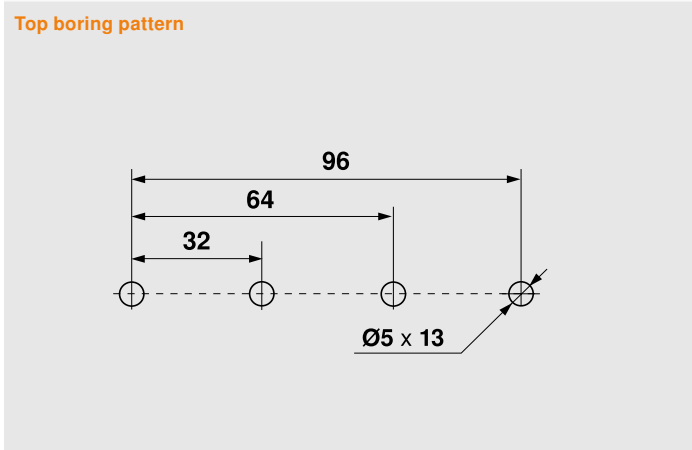

Positioning the drive unit

One drive unit can be positioned anywhere along the height of the bracket

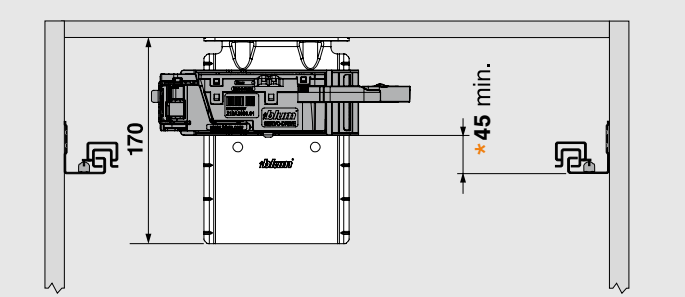

*For most standard applications. May have to be raised in some narrow applications.

Installation of top bracket with adapter

1 Feed cable into the drive unit attachment bracket

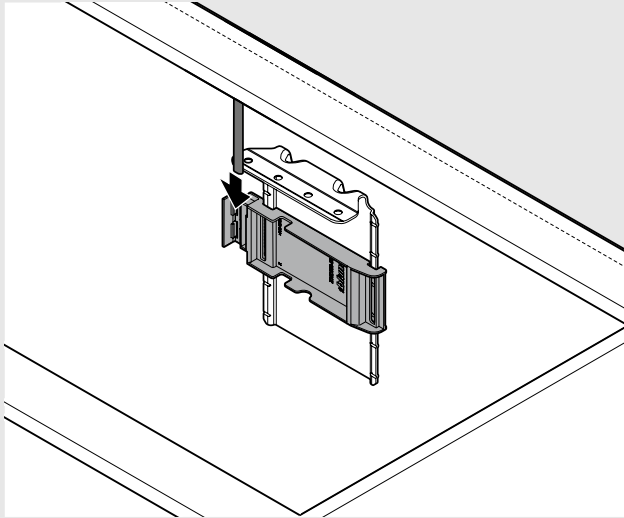

2 Secure with four system screws (661.1300.HG)

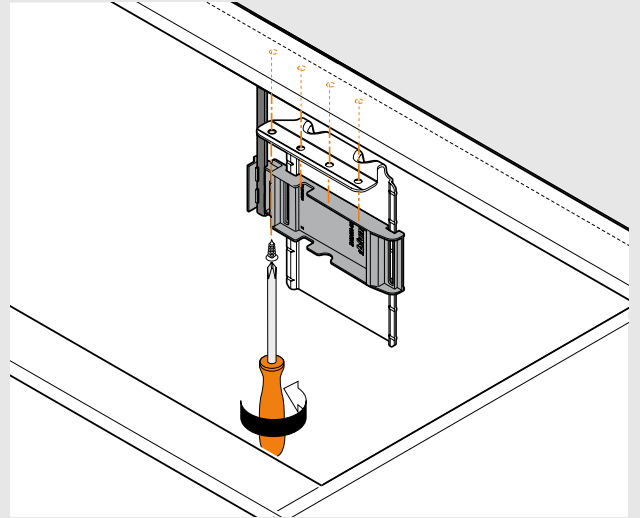

Wiring options

page 51



Top bracket with adapter

A

Part no.

Top bracket with adapter	Z10D6252
Installation screw	661.1300.HG

Drive unit

B

Part no.

Installation	page 53	Drive unit	Z10A3000.04
--------------	---------	------------	--------------------



TANDEM depth adjustable locking device

C Provides 3 (1/8") gap



Part no.

TANDEM depth adjustable locking device, left

T51.1901.PS L

TANDEM depth adjustable locking device, right

T51.1901.PS R

MOVENTO add-on depth adjustment

C One set per drawer



Part no.

298.7600

Power supply set

Set includes:

- 19 ft universal cable
- 72 watt power supply
- Wall mount bracket
- Two-prong power cord
- Cable end protector (qty 3)
- INSERTA cable connector
- Cable clips (qty 10)
- Technical information

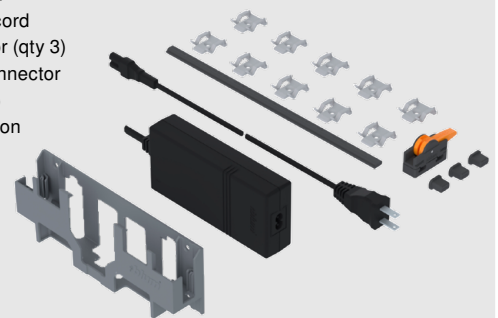

Part no.

Z10NE04UG22

Specifications

Space requirements

For opening widths **430** (16-15/16") and wider

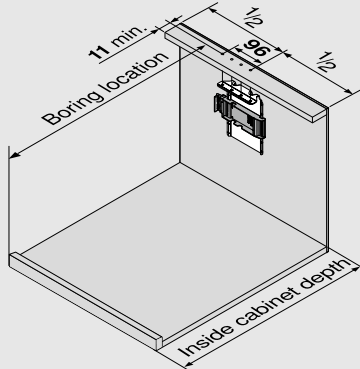

For opening widths **305 to 430** (12" – 16-15/16")

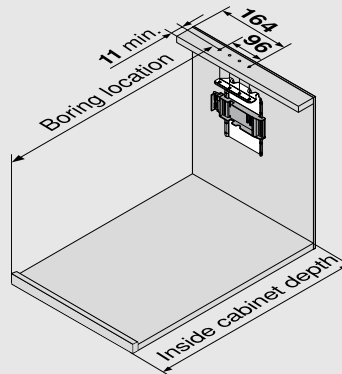

Boring specifications

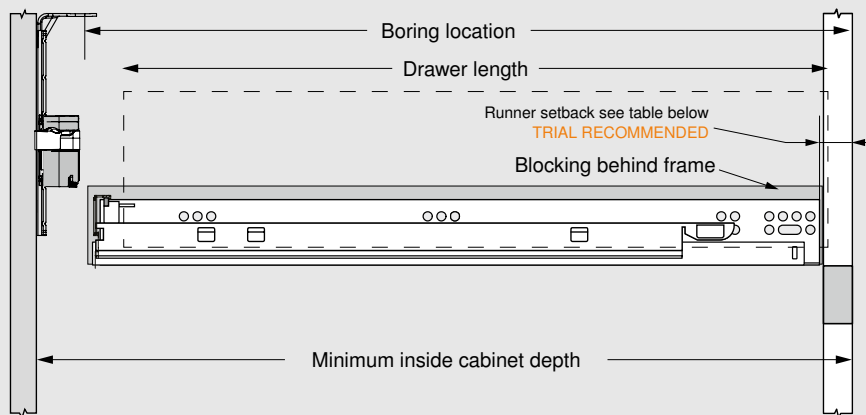

Boring location requirements

boring location = drawer length + 1 (1/32") + runner setback

minimum inside cabinet depth = drawer length + 41 (1-5/8") + runner setback

Calculating runner setback

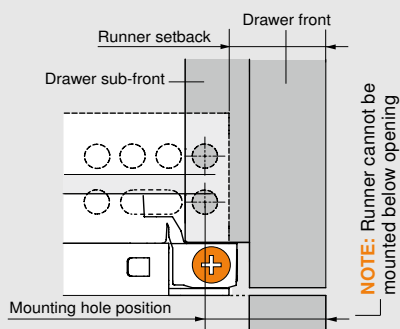

TANDEM plus BLUMOTION

563 H/. (sub-front thickness + drawer front thickness minus 9 (11/32") = runner setback)

563 F (sub-front thickness + drawer front thickness minus 12 (15/32") = runner setback)

- These setbacks recess the face of the drawer front inside of the cabinet 1 (1/32")
- The depth adjustment can then be used to move the drawer front out to its desired position, 2.5 (3/32") out adjustment only

MOVENTO

763H/. and 769. (sub-front thickness + drawer front thickness minus 9.5 (3/8") = runner setback)

769R (sub-front thickness + drawer front thickness + 5 (3/16") = runner setback)

- These setbacks recess the face of the drawer front inside of the cabinet 0.5 (1/32")
- The depth adjustment can then be used to move the drawer front in or out to its desired position ±2 (3/32")

NOTE: For mounting hole position, add 7 (9/32") to runner setback

Boring specifications

Top boring pattern

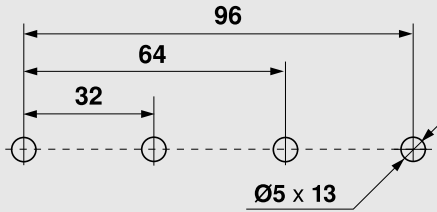

Positioning the drive unit

One drive unit can be positioned anywhere along the height of the bracket

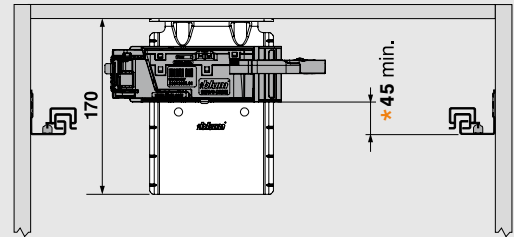

*For most standard applications. May have to be raised in some narrow applications.

Installation of top adapter

1 Feed cable into the drive unit attachment bracket

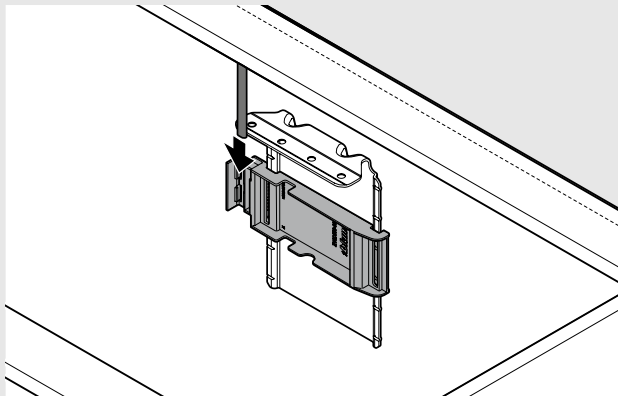

Wiring options

page 51

2 Secure with four system screws (661.1300.HG)

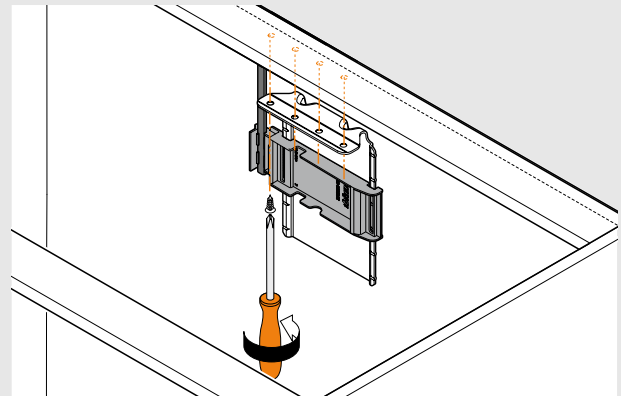

TANDEM depth adjustable locking device



Installation

page 54

- Ideal for inset applications and any SERVO-DRIVE application
- Captive right device and self-aligning left device
- Self-adjusting drawer length tolerance
- Steel base with synthetic, spring-loaded release levers
- Minimum inside drawer width **170** (6-11/16")
- Height adjustment **+3** (1/8")
- Side-to-side adjustment ± 1.5 (1/16")
- Depth adjustment **+2.5** (3/32"), preset at **0**
- Minimum sub-front thickness **13** (1/2")
- Designed for **13** (1/2") drawer bottom recess
- Integrated **3** (1/8") distance bumper for inset or overlay SERVO-DRIVE applications

MOVENTO add-on depth adjustment



- Depth adjustment ± 2 (3/32"), preset at **0**
- Integrated **3** (1/8") distance bumper for inset or overlay SERVO-DRIVE applications
- One set per drawer



Bottom bracket

A

NOTE: 800 (31-1/2") universal cable is included

	Part no.
Bottom bracket, double for two drive units	Z10D7201.01
Installation screw	606N or 606P

Drive unit

B

Installation	page 53	Drive unit	Part no.
			Z10A3000.04

Blum distance bumper

C Provides 3 (1/8") gap

	Part no.
Installation	1 Ø5 bumper
page 50	2 Screw-on bumper
	993.0531
	993.1220



Power supply set

Set includes:

- 19 ft universal cable
- 72 watt power supply
- Wall mount bracket
- Two-prong power cord
- Cable end protector (qty 3)
- INSERTA cable connector
- Cable clips (qty 10)
- Technical information

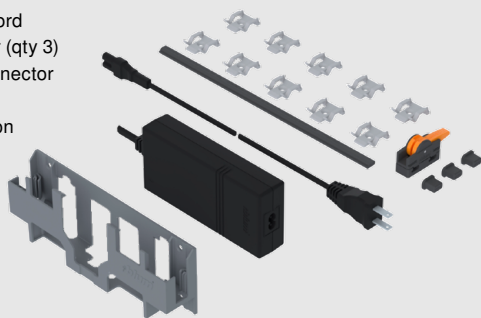

Part no.

page 46 Power supply set

Z10NE04UG22

SERVO-DRIVE uno (includes all parts for a single bottom drawer application)

Waste/recycle sets can be used with our pre-assembled MOVENTO or TANDEMBOX waste/recycle sets (which have crossrails for locating this set)

Bottom bracket sets are great for other bottom waste/recycle or base pot and pan drawer applications.

Part no.

page 44 Waste/recycle set

Z10UB00UG50

page 45 Bottom bracket set

Z10UB00UG

Specifications

For the most up-to-date planning information, refer to the Product Configurator for your specific application.

Space requirements Web code – SERVO-DRIVE **DQIGUM**

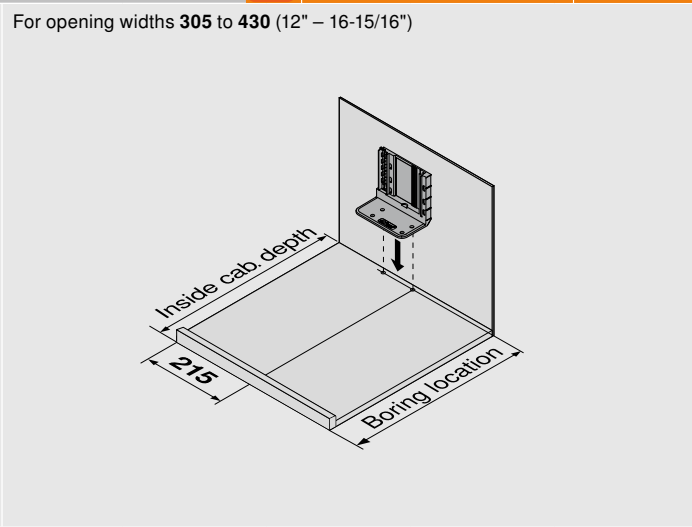
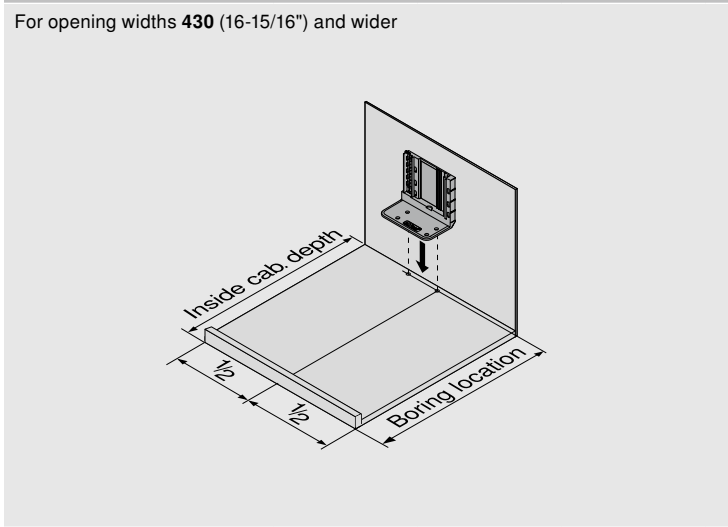

Boring location requirements for MOVENTO and TANDEM plus BLUMOTION Web code – MOVENTO / TANDEM plus BLUMOTION **DQIBXA**

Drawer length	229 (9")	305 (12")	381 (15")	457 (18")	533 (21")	610 (24")	686 (27")	762 (30")
Boring location	253 (9-15/16")	329 (12-15/16")	405 (15-15/16")	481 (18-15/16")	557 (21-15/16")	634 (24-15/16")	710 (27-15/16")	786 (30-15/16")
Min. inside cabinet depth	270 (10-5/8")	346 (13-5/8")	422 (16-5/8")	498 (19-5/8")	574 (22-5/8")	651 (25-5/8")	727 (28-5/8")	803 (31-5/8")

Boring location requirements for LEGRABOX, MERIVOBX and TANDEMBOX Web code – LEGRABOX / MERIVOBX / TANDEMBOX **DQIB7Y**

Actual Cabinet Profile Length	270 (10-5/8")	350 (13-3/4")	400 (15-3/4")	450 (17-11/16")	500 (19-11/16")	550 (21-5/8")	600 (23-5/8")	650 (25-9/16")
Boring location	289 (11-3/8")	369 (14-1/2")	419 (16-1/2")	469 (18-7/16")	519 (20-7/16")	569 (22-3/8")	619 (24-3/8")	669 (26-5/16")
Min. inside cabinet depth	306 (12-1/16")	386 (15-3/16")	436 (17-3/16")	486 (19-1/8")	536 (21-1/8")	586 (23-1/16")	636 (25-1/16")	686 (27")

NOTE: **41 (1-5/8")** is required between drawer back and back panel

Boring specifications

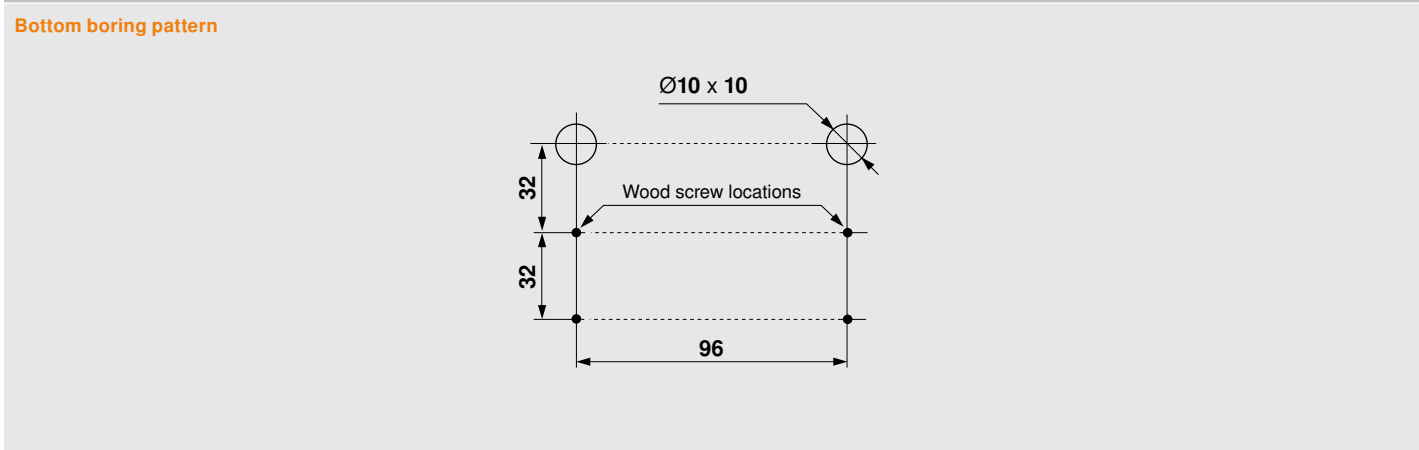

Installation of bottom bracket

1 Insert locating pins into pre-bored holes

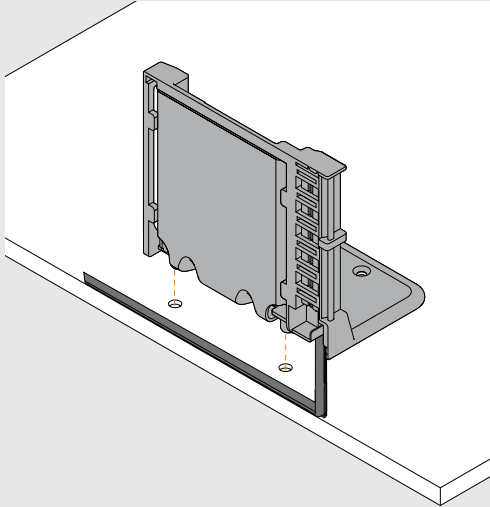

2 Secure with four wood screws (606N or 606P)

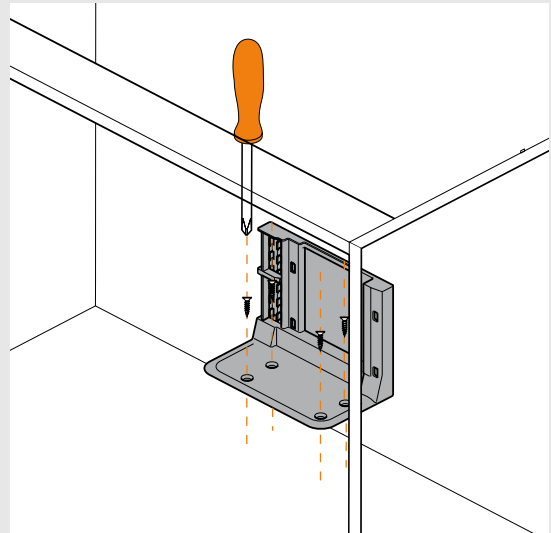
**Drive unit attachment**

Bottom bracket for attachment of one or two drive units

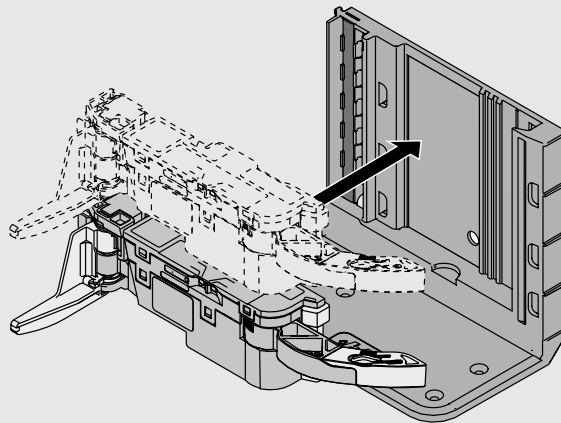

Wiring options

page 51



Bottom bracket

A

NOTE: 800 (31-1/2") universal cable is included

	Part no.
Bottom bracket, double for two drive units	Z10D7201.01
Installation screw	606N or 606P

Drive unit

B

Installation	page 53	Drive unit	Part no.
			Z10A3000.04

TANDEM depth adjustable locking device

C Provides 3 (1/8") gap

	Part no.
TANDEM depth adjustable locking device, left	T51.1901.PS L
TANDEM depth adjustable locking device, right	T51.1901.PS R



MOVENTO add-on depth adjustment

C



- Depth adjustment ± 2 (3/32"), preset at 0
- Integrated 3 (1/8") distance bumper for inset or overlay SERVO-DRIVE applications
- One set per drawer

Part no.

298.7600

Power supply set

Set includes:

- 19 ft universal cable
- 72 watt power supply
- Wall mount bracket
- Two-prong power cord
- Cable end protector (qty 3)
- INSERTA cable connector
- Cable clips (qty 10)
- Technical information

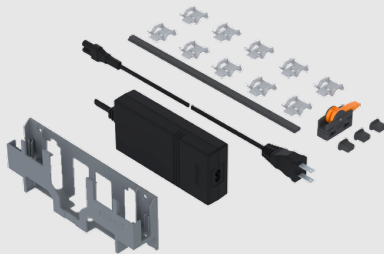

Part no.

page 46

Power supply set

Z10NE04UG22

SERVO-DRIVE uno (includes all parts for a single bottom drawer application)

Waste/recycle sets can be used with our pre-assembled MOVENTO or TANDEMBOX waste/recycle sets (which have crossrails for locating this set)

Bottom bracket sets are great for other bottom waste/recycle or base pot and pan drawer applications.

Part no.

page 44

Waste/recycle set

Z10UB00UG50

page 45

Bottom bracket set

Z10UB00UG

Specifications

Space requirements

For opening widths **430** (16-15/16") and wider

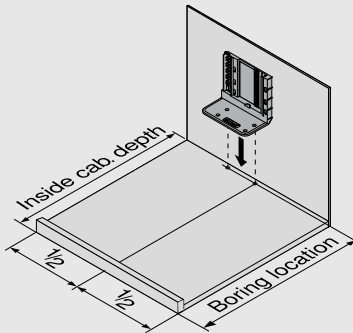

For opening widths **305 to 430** (12" – 16-15/16")

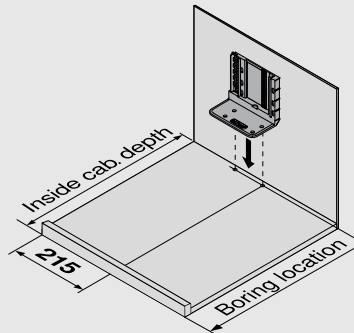

Boring specifications

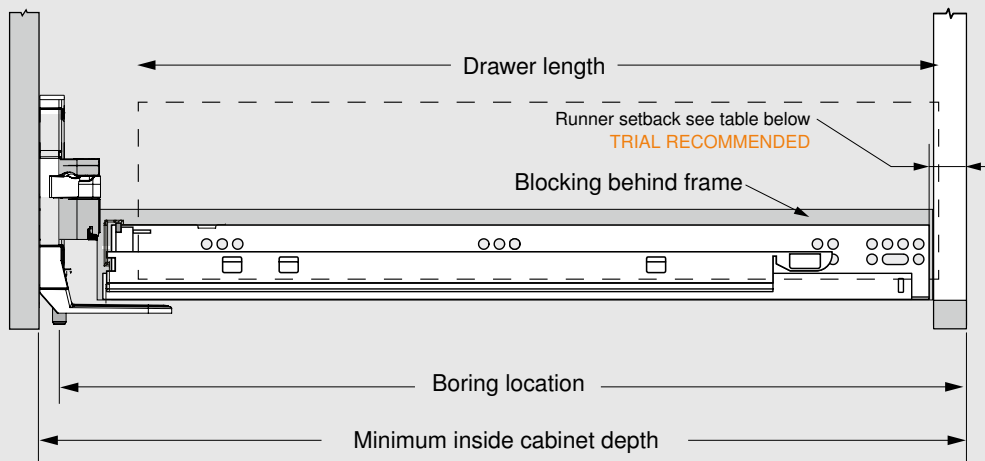

Boring location requirements

Boring location = drawer length + **21** (13/16") + runner setback

Minimum inside cabinet depth = drawer length + **41** (1-5/8") + runner setback

Calculating runner setback

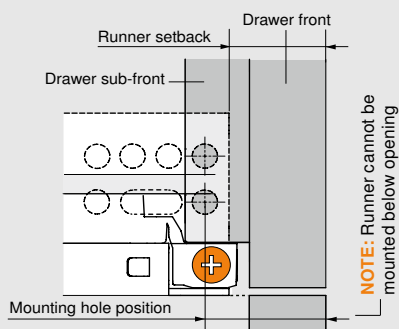

TANDEM plus BLUMOTION

563 H/. (sub-front thickness + drawer front thickness minus **9** (11/32") = runner setback)

563 F (sub-front thickness + drawer front thickness minus **12** (15/32") = runner setback)

- These setbacks recess the face of the drawer front inside of the cabinet **1** (1/32")
- The depth adjustment can then be used to move the drawer front out to its desired position, **2.5** (3/32") out adjustment only

MOVENTO

763H/. and 769. (sub-front thickness + drawer front thickness minus **9.5** (3/8") = runner setback)

769R (sub-front thickness + drawer front thickness + **5** (3/16") = runner setback)

- These setbacks recess the face of the drawer front inside of the cabinet **0.5** (1/32")
- The depth adjustment can then be used to move the drawer front in or out to its desired position **±2** (3/32")

NOTE: For mounting hole position, add **7** (9/32") to runner setback

Boring specifications

Bottom boring pattern

Ø10 x 10

32

32

96

Wood screw locations

TANDEM depth adjustable locking device



- Ideal for inset applications and any SERVO-DRIVE application
- Captive right device and self-aligning left device
- Self-adjusting drawer length tolerance
- Steel base with synthetic, spring-loaded release levers
- Minimum inside drawer width **170** (6-11/16")
- Height adjustment **+3** (1/8")
- Side-to-side adjustment **±1.5** (1/16")
- Depth adjustment **+2.5** (3/32"), preset at **0**
- Minimum sub-front thickness **13** (1/2")
- Designed for **13** (1/2") drawer bottom recess
- Integrated **3** (1/8") distance bumper for inset or overlay SERVO-DRIVE applications

Installation

page 54

MOVENTO add-on depth adjustment



- Depth adjustment **±2** (3/32"), preset at **0**
- Integrated **3** (1/8") distance bumper for inset or overlay SERVO-DRIVE applications
- One set per drawer

Installation of bottom bracket

1 Insert locating pins into pre-bored holes

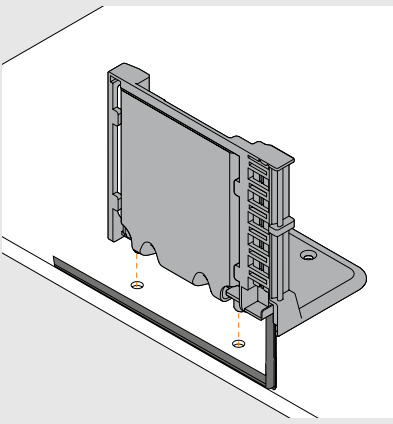

2 Secure with four wood screws (606N or 606P)

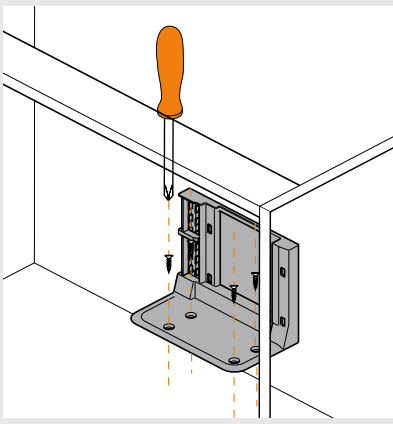

Drive unit attachment

Bottom bracket for attachment of one or two drive units

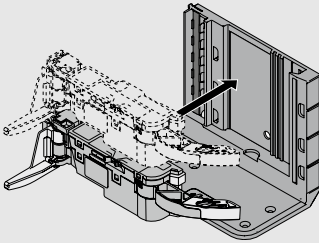

Wiring options

page 51



SERVO-DRIVE for waste/recycle set installation

SERVO-DRIVE waste/recycle set



Set includes:

- 1 Drive unit (pre-attached)
- 2 Double bottom bracket with #6 x 1" wood screws (qty 2)
- 3 Adapter plate
- 4 110 volt plug-in power supply with six foot of universal cable
- 5 Screw-on distance bumpers (qty 4) with #6 x 5/8" wood screws for installation (qty 8)
- 6 INSERTA cable connector
- 7 Cable end protectors (qty 2)
- 8 Cable clips (qty 4)

— Installation template, instructions and user manual

Part no.

SERVO-DRIVE waste/recycle set

Z10UB00UG50

NOTE: Power supply will operate up to two drive units in a double bottom bracket application (second drive unit sold separately)



SERVO-DRIVE bottom bracket set

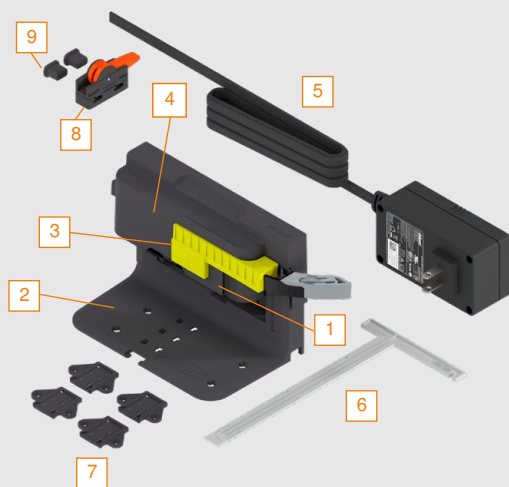

Set includes:

- 1 Drive unit (pre-attached)
 - 2 Single bottom bracket with #6 x 5/8" wood screws (qty 4)
 - 3 Transport protection and spacer for setting depth
 - 4 Drip protection
 - 5 110 volt plug-in power supply with six foot of universal cable
 - 6 Assembly device
 - 7 Screw-on distance bumpers (qty 4) with #6 x 5/8" wood screws for installation (qty 8)
 - 8 INSERTA cable connector
 - 9 Cable end protectors (qty 2)
- Installation template, instructions and user manual

Part no.

SERVO-DRIVE bottom bracket set

Z10UB00UG

Wall mount power supply set



Wall mount power supply set

Suitable for up to 50 SERVO-DRIVE for drawers drive units

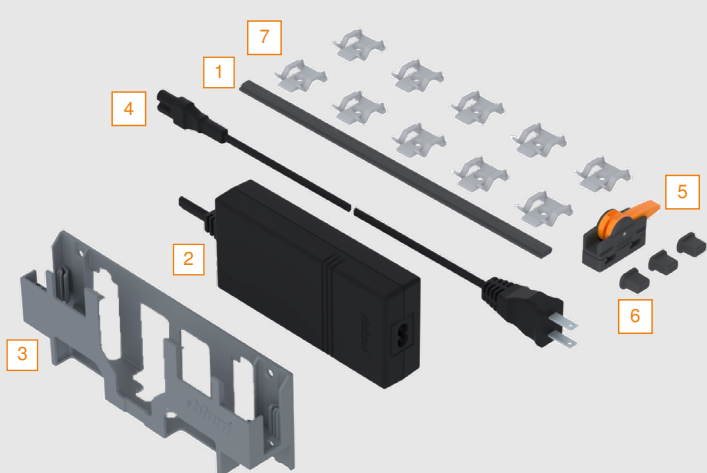

Set includes:

- 1 19 ft universal cable
- 2 72 watt power supply
- 3 Wall mount bracket
- 4 Two-prong cord
- 5 INSERTA cable connector
- 6 Cable end protector (qty 3)
- 7 Cable clips (qty 10)

— Installation instructions and user manual

Part no.

Wall mount power supply set

Z10NE04UG22

One or two sets: based on your kitchen layout

One or two power supply sets may be needed depending on your kitchen layout. When the cabinets are placed directly next to each other, one set may be enough. Two sets are required for an island kitchen or a double row "galley" kitchen.

Various kitchen layouts

One wall mount power supply set:

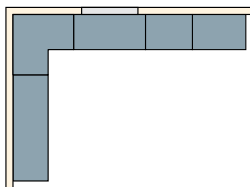

L Shaped

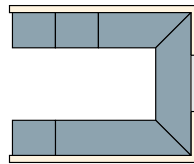

U Shaped

Two wall mount power supply sets:

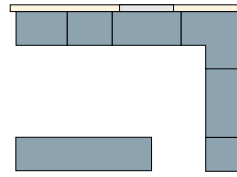

L with Island



Galley

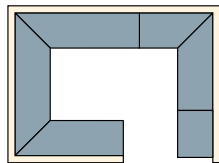

G Shaped



Line

Plug-in power supply set



Plug-in power supply set

Only suitable for one drive unit



Set includes:

- SERVO-DRIVE plug-in power supply
- 1120 (44-1/8") cable (with SERVO-DRIVE distribution cable extendable to maximum of 2000 (78-3/4"))
- Installation instructions and user manual

Part no.

Plug-in power supply set

Z10NA40UG

Wall mount power supply

Wall mount power supply	
	<p>Supplies power to the drive units</p> <ul style="list-style-type: none"> – Energy Star Level VI – UL certified – Can power up to 50 SERVO-DRIVE for drawers drive units – Connect to switched GFCI outlet – Cable length is six foot – Two prong power cord included
	Part no.
Wall mount power supply	Z10NE04UG

Input specifications	
Input voltage	100-240 VAC
Input frequency	50-60 Hz
Input current	2.5 A
Inrush current	100 A maximum at 240 VAC
Protection class	Class I
Earth leakage current	3.5 mA maximum
General specifications	
Average active efficiency	≥ 88%
Switching frequency	65 kHz typical
No load loss (standby)	≤ 0.15 W
Energy Star	Level VI
Safety / Approvals	
EN / IEC	60950, 60335-1
UL	60950-1

Output specifications	
Output voltage	24 VDC
Output power	72 W continuous
Output current	3.0 A
Minimum load	None
Over voltage protection	At 33 VDC
Overload protection	10.5 A hiccup trip and restart mode with auto recovery
Short circuit protection	Continuous
Environmental information	
Storage temperature	-4° F to 185° F
Operating temperature	32° F to 104° F
Maximum altitude	13,123 ft
Protection	IP40

Plug-in power supply

Plug-in power supply set	
Only suitable for one drive unit	
	<p>Set includes:</p> <ul style="list-style-type: none"> – SERVO-DRIVE plug-in power supply – 1120 (44-1/8") cable (with SERVO-DRIVE distribution cable extendable to maximum of 2000 (78-3/4")) – Installation instructions and user manual
	Part no.
Plug-in power supply set	Z10NA40UG

Input specifications	
Input voltage	100–240 VAC
Input frequency	50–60 Hz
Input current	2.0 A
General specifications	
Average active efficiency	≥ 86.4%
No load loss (standby)	≤ 0.10 W

Output specifications	
Output voltage	24.0 V DC
Output power	24.0 W
Output current	1.0 A
Environmental information	
Storage temperature	-4° F to 185° F
Operating temperature	32° F to 104° F
Maximum altitude	13,123 ft
Protection	IP40

Wall mount bracket for power supply

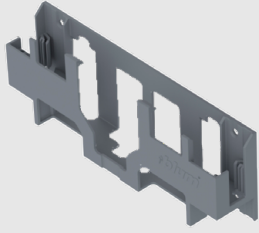

Installation
page 53

Wall mount bracket	Z10NG120
Installation screw	606N or 606P

INSERTA cable connector



Installation
page 52

INSERTA cable connector	Z10V1000.01
-------------------------	-------------

Cable clip

Adhesive back and/or screw-on

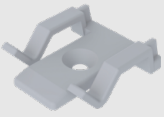

Part no.

Cable clip	Z10K0009
Installation screw	606N or 606P

INSERTA cable connector set

Set includes:

- INSERTA cable connector
- Cable end protector (qty 2)



Part no.

Cable connector set	Z10V100E.01
---------------------	-------------

Synchronization cables

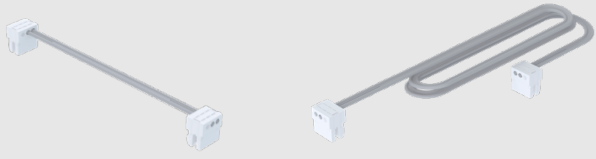

Installation
page 51

80 (3") synchronization cable	Z10K008S
1200 (4') synchronization cable	Z10K120S

Universal cable

Length 26 ft with five cable end protectors



Part no.

Universal cable	Z10K800AE
-----------------	-----------

Cable end protector



Part no.

Cable end protector	Z10K0008
---------------------	----------

Drawer front distance bumper

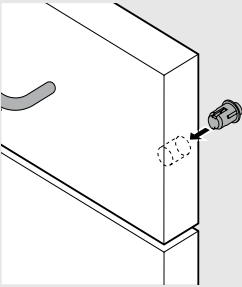

- For drawer heights **305 (12")** or less two distance bumpers are required
- Center bumpers vertically left/right side of drawer front

- For drawer heights **305 (12")** and greater
- Four distance bumpers are required

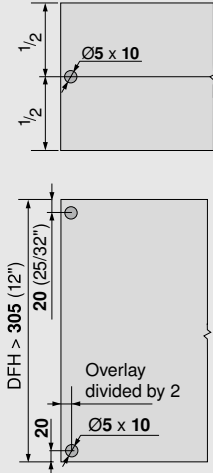

NOTE: Blum distance bumpers provide a travel of **3 (1/8")**

Ø5 bumper	Part no. 993.0531
------------------	-----------------------------

Screw-on distance bumper

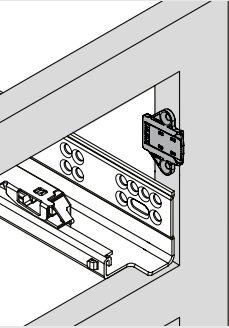

- For use with face frame or panel cabinets
- Can be mounted to side or bottom of cabinet opening
- Pre-bore with **Ø2.5** drill bit

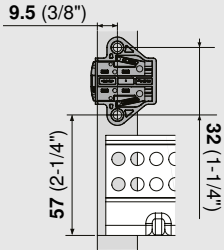

NOTE: Blum distance bumpers provide a travel of **3 (1/8")**

Screw-on bumper	Part no. 993.1220
Installation screw	606N or 606P

TANDEM depth adjustable locking device

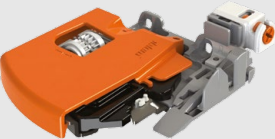

- Ideal for inset applications and any SERVO-DRIVE application
- Captive right device and self-aligning left device
- Self-adjusting drawer length tolerance
- Steel base with synthetic, spring-loaded release levers
- Minimum inside drawer width **170 (6-11/16")**
- Height adjustment **+3 (1/8")**
- Side-to-side adjustment **±1.5 (1/16")**
- Depth adjustment **+2.5 (3/32")**, preset at **0**
- Minimum sub-front thickness **13 (1/2")**
- Designed for **13 (1/2")** drawer bottom recess
- Integrated **3 (1/8")** distance bumper for inset or overlay SERVO-DRIVE applications

Part no.

TANDEM depth adjustable locking device, left	T51.1901.PS L
TANDEM depth adjustable locking device, right	T51.1901.PS R
Installation screw	606N or 606P

Installation page 54

MOVENTO add-on depth adjustment



Part no.

One set per drawer	298.7600
--------------------	-----------------

Two base cabinets connected

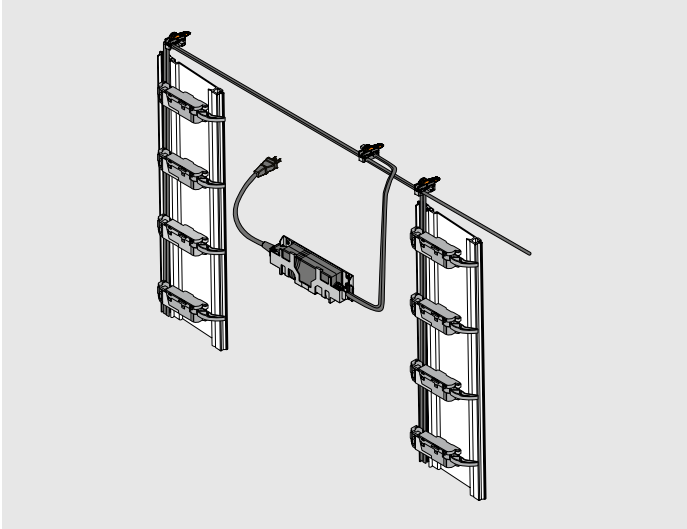

Individual drawer with top bracket

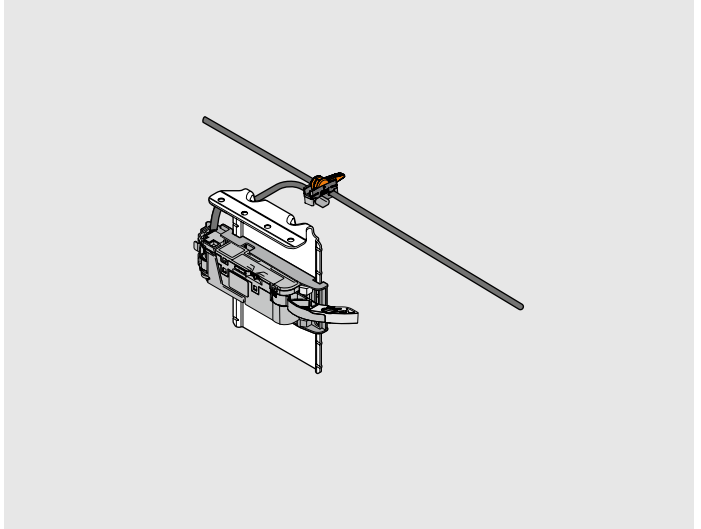

Cabinet with different applications

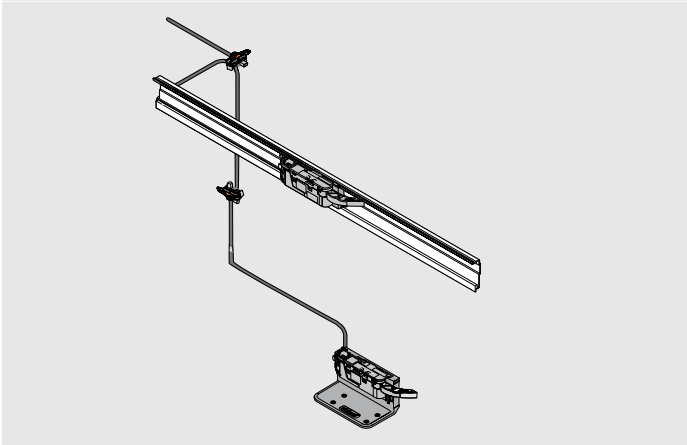

Bottom drawer with bottom bracket

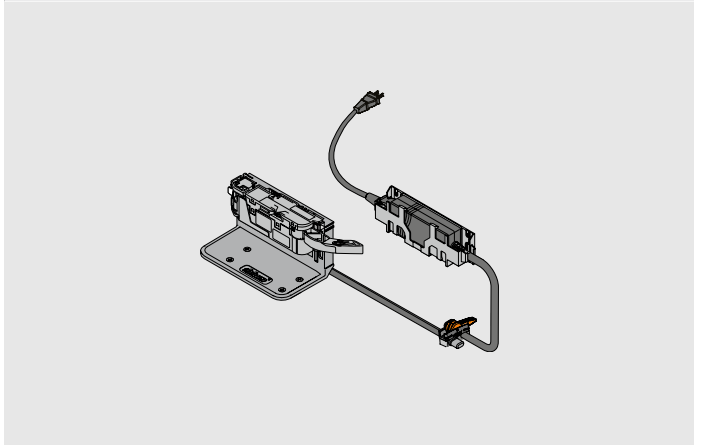

Two drawers connected with synchronization cable

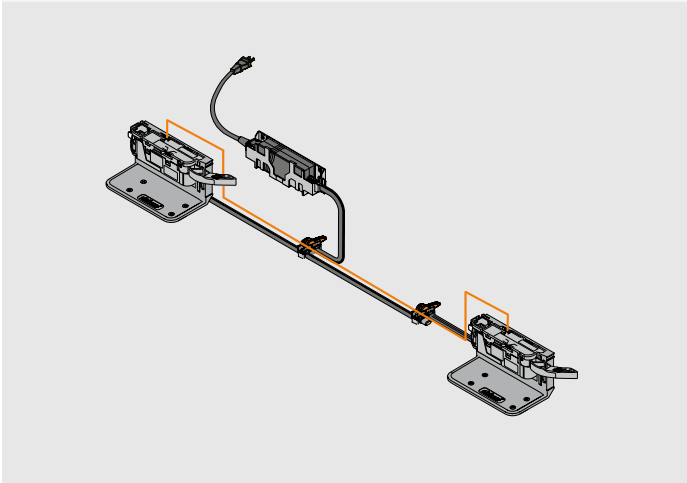

- Required when two drive units should open simultaneously
- Can be used in a variety of applications
- Connects directly to the back of the drive unit
- Available in two different lengths
- Cable color: cream

NOTE: Synchronization cable marked in orange

Installing cable onto vertical profile

- 1 Insert cable for power into the left channel of profile
- 2 Insert cable for communication into the right channel of profile

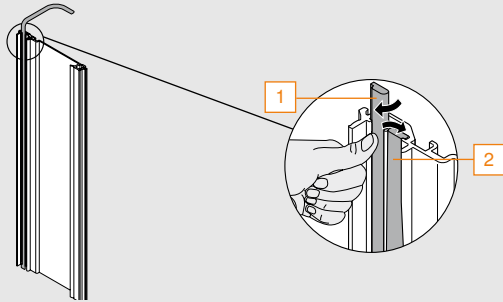

Installing cable onto bottom bracket

Insert cable from the rear of the bottom bracket

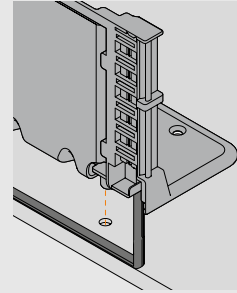

Installing cable onto horizontal profile

- 1 Insert cable for power into the bottom profile
- 2 Wrap cable behind profile

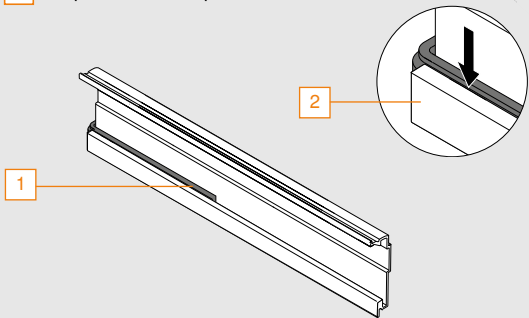

Installing cable onto horizontal adapter

Insert cable for power into the left channel of adapter

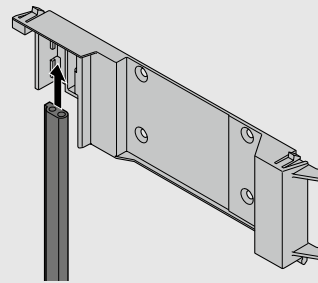

Installing cable connector

- 1 Insert cable for distribution into open slot
- 2 Insert cable for power into open slot
- 3 Rotate orange lever to lock into place
- 4 Slide cable end protector over exposed cable

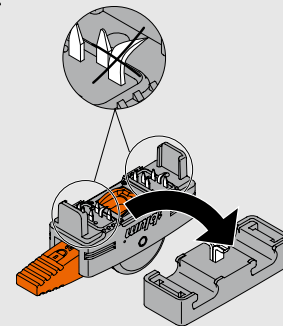
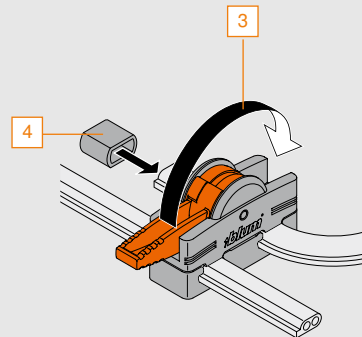
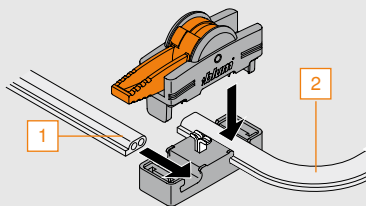

NOTE: Ensure piercing pins are not damaged



SERVO-DRIVE assembly,
adjustment and removal
www.blum.com

Installation of power supply

Minimum space requirements

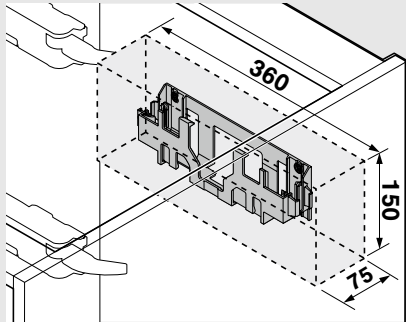

- 1 Insert power cord into power supply
- 2 Insert power supply into wall mount bracket

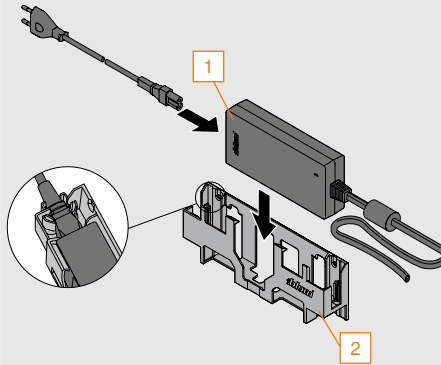

- 3 Attach wall mount bracket with four 606N or 606P screws

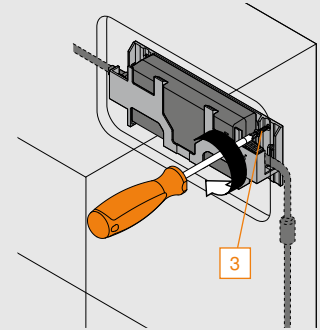

NOTE: Power supply can be mounted horizontally or vertically onto back panel

Drive unit installation

- 1 Open release lever and insert right hand side of drive unit

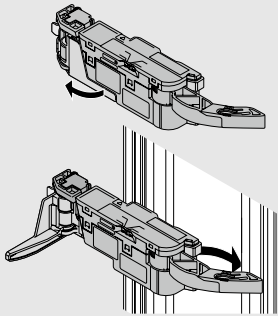

- 2 Open clip and align onto the profile slot and secure clip

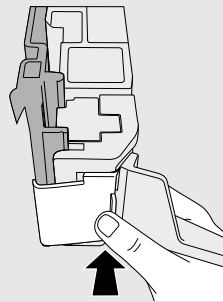

- 3 Close release lever

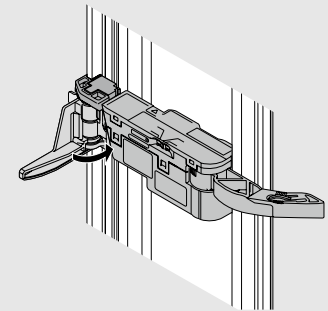

Drive unit removal

- 1 Open release lever

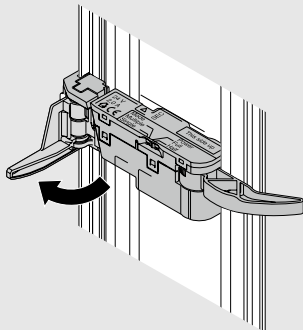

- 2 Lift up clip

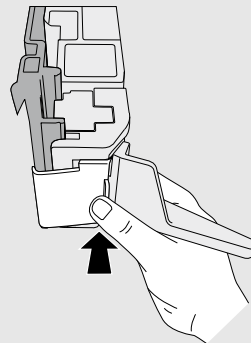

- 3 Pull outward and lift off profile

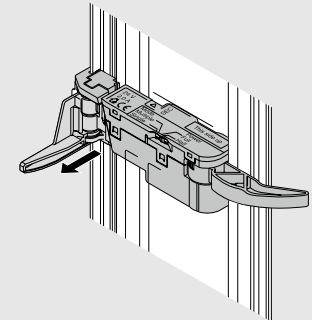

Installing synchronization cable

- 1 Insert synchronization cable into back of drive unit

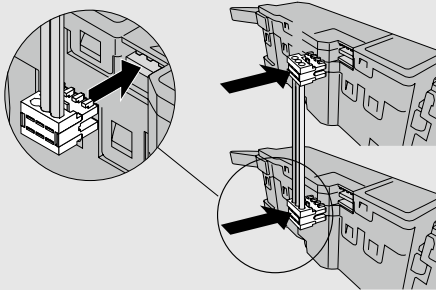

- 2 Reattach drive units

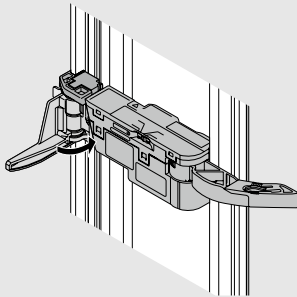

Drive unit adjustment

- 1 **Status LED (Green)**
Once everything is installed, cycle the drawer one time:
 - Solid light: power available and correct drive unit location (in depth)
 - Flashing light: incorrect drive unit location (in depth)
 - Off: no power from source (check source and cabling)
- 2 **Mode selection switch (uses communication cable)**
Single: Drive unit only moves when activated directly (standard setting)
Multiple: Drive unit moves when another drive unit on the same communication cable is activated
- 3 **Activation sensitivity switch**
Full (+): For most drawers (standard setting)
Half (-): For drawers that are more likely to be leaned against or accidentally activated
- 4 **Power selection switch**
Full (+): For most drawers (standard setting)
Half (-): For very small, short and/or light drawers

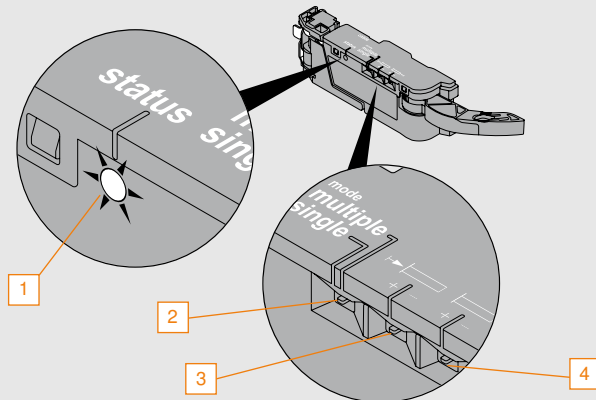

Lever arm extension

The drive unit comes with the lever arm extension pre-attached. The lever arm extension may need to be removed in some narrow applications.

- 1 Press release button
- 2 Pull

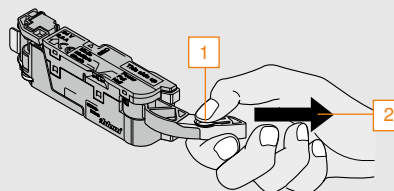

Installing the locking devices

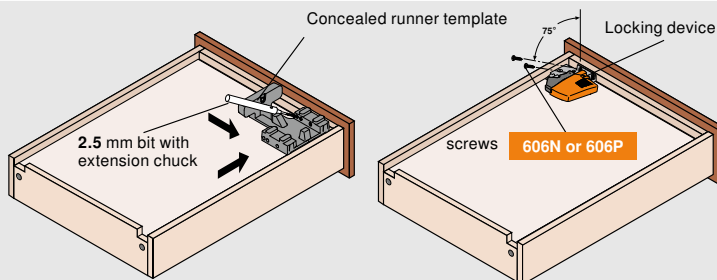

- 1 Position the 2.5 mm drill bit into the extension chuck so that it will bore 10 (13/32") deep
- 2 Place template into the front corner of the drawer
- 3 Bore two holes and repeat on other side
- 4 Attach locking devices with #6 x 5/8" deep thread wood screws (606N or 606P)

The mounting screws must go in at a precise angle and the locking device must fit flush to the drawer bottom to ensure proper function of the complete drawer system.

NOTE: Using the T65.1600.01 Concealed runner template is highly recommended

Removing vertical profile from top and bottom adapters

- 1 Use screwdriver to assist in removing right side of adapters
- 2 Remove profile from cabinet

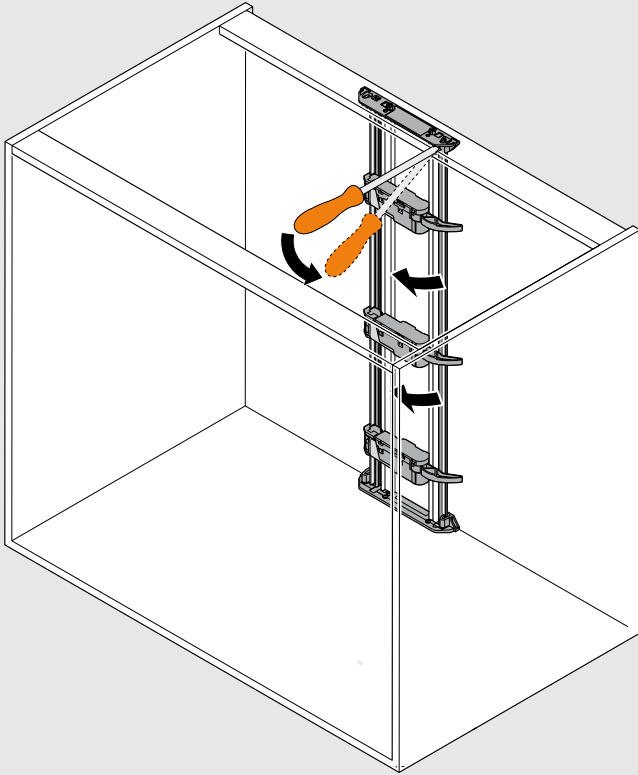

Removing vertical profile from back and bottom adapters

- 1 Use screwdriver to assist in removing right side of back adapter
- 2 Remove profile from cabinet

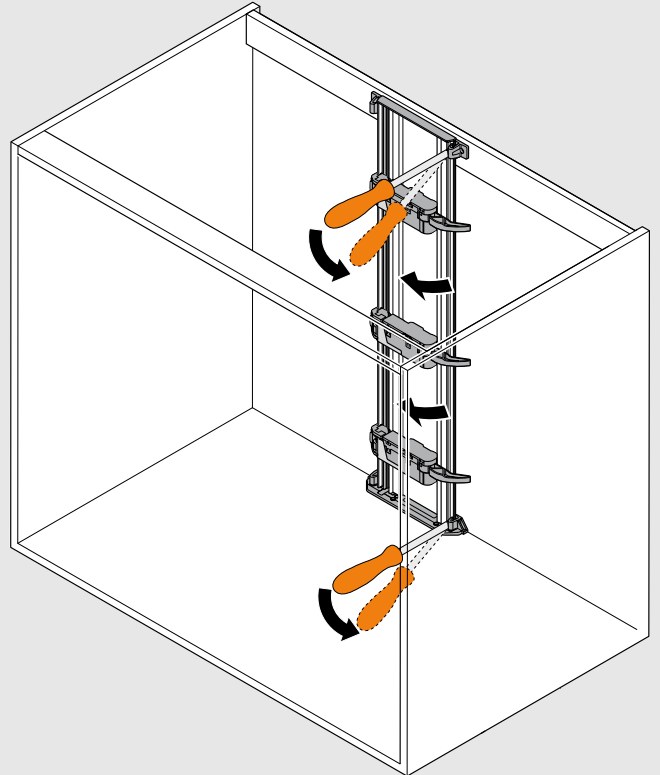

Removing horizontal profile

- 1 Use screwdriver to assist in removing profile from adapters
- 2 Remove profile from cabinet

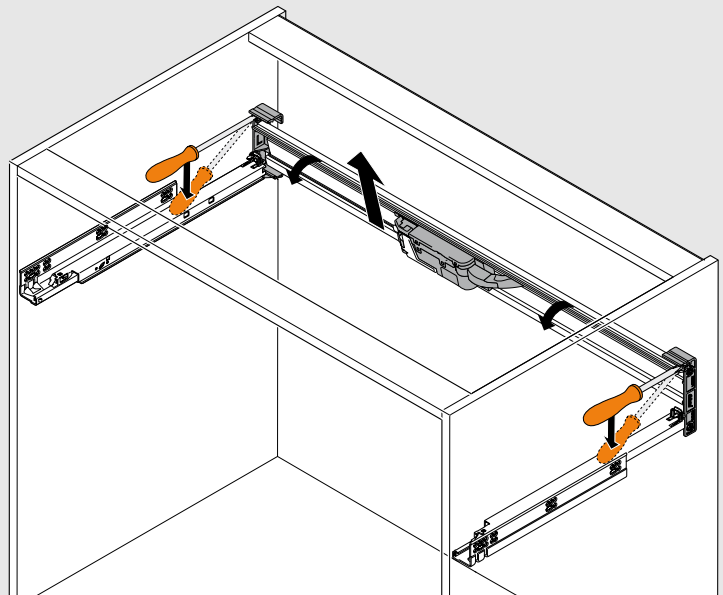

Concealed runner template

Components

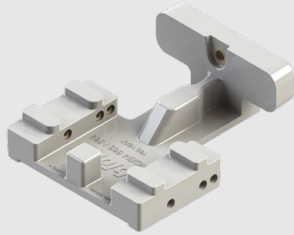

- Essential tool for drawers using Concealed runners
- To bore the $\varnothing 6$ holes for rear hooks
- Pre-bore $\varnothing 2.5$ hole for Concealed runner locking devices at the required angle

Part no.

Concealed runner template	T65.1600.01
Accessories (order separately)	
$\varnothing 2.5$ drill bit	DB-2.5mm
$\varnothing 6$ drill bit	DB-6mm
Tool set	T65.9000

Rear notching

Dimensions

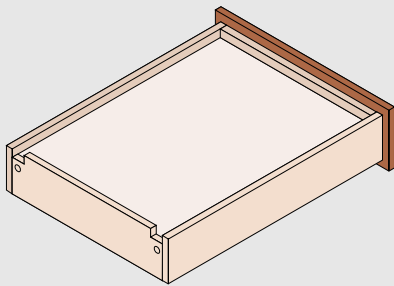

Drawers must be notched in the back to accommodate concealed runners

Rear view

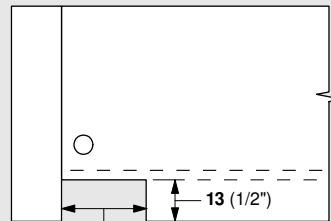

* 35 (1-3/8") Minimum rear notch

* 50 (1-15/16") Minimum rear notch for MOVENTO

The notches must be flush with the drawer sides and bottom

Option – no notching

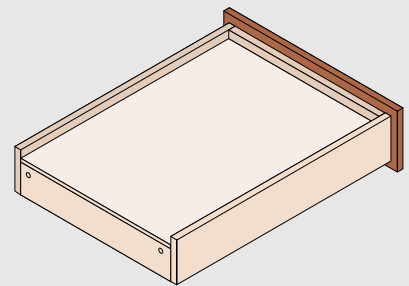

Make the back panel shorter and extend the drawer bottom to the back of the drawer

Rear boring

Dimensions

Rear view

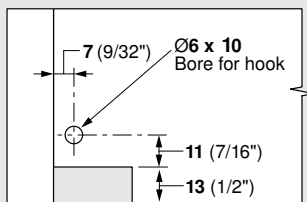

Drawers require 6 holes bored on each side of the back panel to accept the hooks on the back of concealed runners

Boring

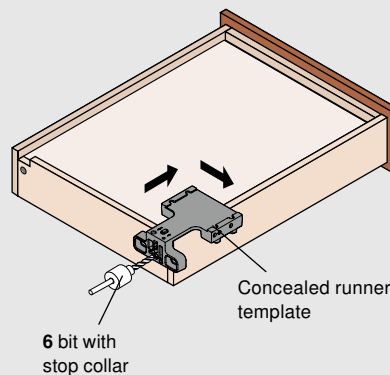

- 1 Place template over the drawer side
- 2 Position template so that the center rib rests against the inside face of the drawer side
- 3 Set stop collar on 6 bit so that it will bore 10 (13/32") deep
- 4 Hold template firmly and bore hole
- 5 Repeat on other side

NOTE: Using the T65.1600.01 Concealed runner template is highly recommended

POZI DRIVER and bits



A POZI screwdriver (different from Phillips) is the most crucial tool you can use to assure that full torque is applied to all Blum POZI mounting screws. POZI screws can be identified by the distinctive “tick” marks located in the center of the screw head recess.

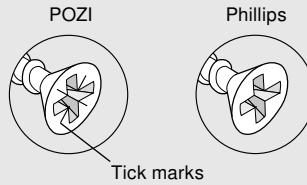

Part no.

#2 POZI DRIVER	POZI DRIVER
1/4" Magnetic bit holder	BIT HOLDER
#2 x 1" POZI bit insert	POZI BIT #2x1
#2 x 2" POZI bit insert	POZI BIT #2x2

Twist drill bits



Part no.

Ø2.5, right handed	DB-2.5mm
Ø5, right handed	DB-5mm
Ø6, right handed	DB-6mm
Ø10, right handed	DB-10mm

Deep thread system screw

Pilot bore Ø5 (3/16") hole



Part no.

#7 x 13 mm, #2 POZI	661.1300.HG
#7 x 11.5 mm, #2 POZI	661.1150.HG

Deep thread wood screw

Pilot bore Ø2.5 (3/32") hole



Part no.

#6 x 5/8", #2 Phillips	606N
#6 x 5/8", #2 POZI	606P

Narrow application adapter

Adapter for narrow applications (for example, SPACE TWIN). Drive units can be installed horizontal (standard) or with the lever arm pointing down.



Part no.

Narrow application adapter	Z10T00B2
----------------------------	-----------------

Metal box systems front stabilization bracket

For use on tall fronted drawers using SERVO-DRIVE. Refer to specific box system brochure for installation information.

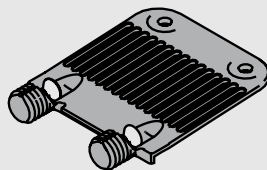

Part no.

Front stabilization bracket	Z96.10E1
-----------------------------	-----------------

Our services at a glance

Our services support you throughout your entire process – from planning and design, all the way through to manufacturing. Take advantage of our tried-and-tested and user-friendly services for your projects with SERVO-DRIVE.



Planning, design, quoting

Product Database offers specific product details, photos and CAD data. Our Product Configurator provides you with checked and complete parts lists specifically for your application.



Assembly, installation

Download our EASY ASSEMBLY App for quick access to assembly and installation instruction sheets and videos. The easy-to-use interface allows you to filter by product type. Save your most used products to your favorites to find the information again quickly.



Ordering

To make it easy to order your SERVO-DRIVE parts, you can manage your different projects and order lists with ease under "My Projects" and "My Order Lists" in the Product Configurator.



Marketing

Using our free Marketing Media Library, you can find photos, videos and logos to assist you in your own marketing efforts.



Manufacturing

CAM data can be downloaded from the Product Configurator to assist you during the cabinet manufacturing process. Have a Blum EASYSTICK? Transfer BXF files from the Product Configurator directly to your machine.



Sign up now for a free E-SERVICES account. e-services.blum.com



Find out more about our E-SERVICES: blum.com/e-services

Part No.	Page No.
298.7600	17, 25, 33, 41, 50
606N	20, 22, 24, 36, 39, 40, 43, 49, 50, 53, 54, 57
606P	20, 22, 24, 36, 39, 40, 43, 49, 50, 53, 54, 57
661.1150.HG	57
661.1300.HG	20, 22, 24, 28, 31, 32, 35, 57
993.0531	13, 21, 28, 36, 50
993.1220	13, 21, 28, 36, 50
BIT HOLDER	57
DB-2.5mm	56, 57
DB-5mm	57
DB-6mm	56, 57
DB-10mm	57
POZI BIT #2x1	57
POZI BIT #2x2	57
POZI DRIVER	57
T51.1901.PS L	17, 25, 33, 40, 50
T51.1901.PS R	17, 25, 33, 40, 50
T65.1600.01	54, 56
T65.9000	56
Z10A3000.04	13, 16, 21, 25, 28, 32, 36, 40
Z10D01E0.01	12, 16
Z10D01EA.01	12
Z10D5210.US	20, 24
Z10D6252	28, 32
Z10D7201.01	36, 40
Z10K0008	49
Z10K008S	49
Z10K0009	49
Z10K120S	49
Z10K800AE	49
Z10NA40UG	47, 48
Z10NE04UG	48
Z10NE04UG22	13, 17, 21, 25, 29, 33, 37, 41, 46
Z10NG120	49
Z10T00B2	57
Z10T720AB	12, 16
Z10T1143B	20, 24
Z10T1170A	12, 16
Z10UB00UG	37, 41, 45
Z10UB00UG50	37, 41, 44
Z10V100E.01	49
Z10V1000.01	49
Z96.10E1	57







moving ideas

At Blum, we pay attention to those small, but valuable, details. We're attentive in everything we do. With our carefully engineered hardware, innovative motion technologies and customized services, we help move your ideas forward. Let's move the world together.



Quality of living

We engineer our products with your lifetime in mind. As your mobility needs change, Blum hardware keeps your cabinets accessible.



Product range

Everything from a single source: Our wide range of products allows you to keep up with the trends of today and tomorrow.



Inspiration

We monitor global trends and strive to create the solutions of tomorrow. We like to share our insights with you.



Innovation

We stay in motion. Our curiosity and pioneering spirit drive us to develop new products and services for you.



Services

We support your daily operations with customized services tailored to your processes.



Quality

We continuously strive to improve our products, services and ourselves.



Trust

It's our goal to build lasting relationships with our customers, employees and in our community.

Julius Blum started our journey in 1952 with horseshoe studs. Today we supply innovative hardware to customers in over 120 countries.

Please visit blum.com for information on other Blum products
LIT-SDR1000.01.26 Ident. 26233740 © 2026 Blum, Inc.

Blum, Inc.
7733 Old Plank Rd.
Stanley, NC 28164
800-438-6788
blum.com

