



Express Eddie's Toolbox



What Kind of Cabinets Do I Have

There are two basic types of cabinets available today:

- Face Frame or Framed cabinets
- Frameless or Box cabinets also called Euro cabinets.

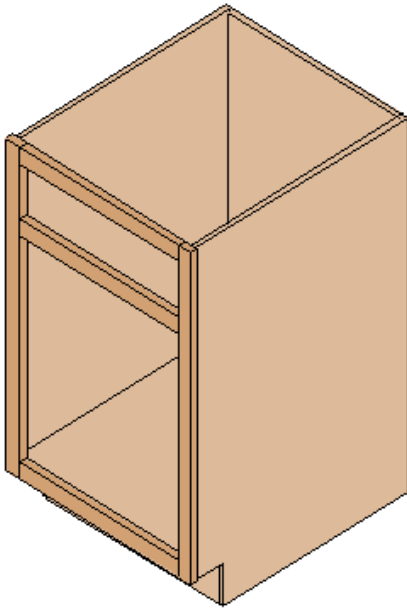

Face Frame / Framed

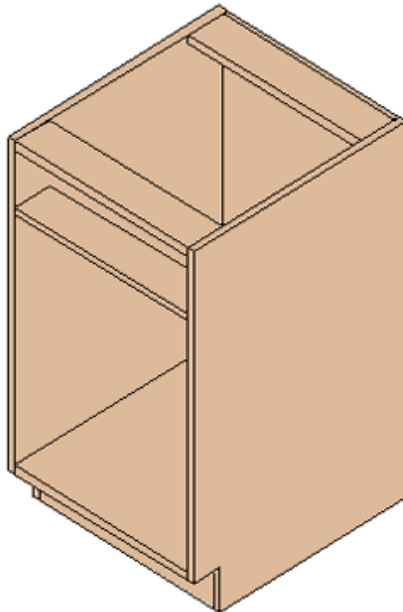

Frameless / Box / Euro

Face Frame / Framed

Face frame cabinets are different from Frameless cabinets in that they have a 1-1/2" to 2" border frame hiding the edge of the cabinet box. The face frame, usually made from solid wood, adds strength and sturdiness. The cabinet door is attached to the frame but doors can also be mounted to the inside of the frame. This style creates a uniform, flush-mounted look. Few cabinets are made of solid wood and framed cabinets typically have a box made from wood products such as plywood, particleboard or medium density fiberboard (MDF).

Frameless / Box / Euro

Frameless cabinets also called box cabinets or Euro cabinets have no face frame and the cabinet doors attach directly to the sides of the cabinet box. Doors typically cover the entire cavity and box creating what is called a full-overlay. Since

there is no frame covering the box, frameless cabinets tend to use the maximum amount of available space. Cabinets and drawers are slightly larger than those constructed with face frames as the full inside width and height of the cabinet box is utilized. Most frameless cabinets are composed of manufactured wood products, such as plywood, particleboard or MDF and are edged with a laminate or wood veneer.