

# Richland Two Door Vanity



## Specifications

- Cam-lock connectors for fast & easy assembly
- Raised panel doors featuring square design
- Solid wood door frames and drawer fronts
- Antique brass hardware with TruMatch™ finish
- Durable water-resistant finish
- Vanity top sold separately
- Nugmeg Oak Finish



## Dimensions

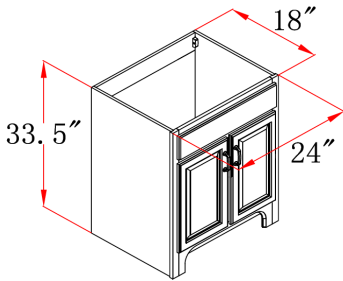

541100

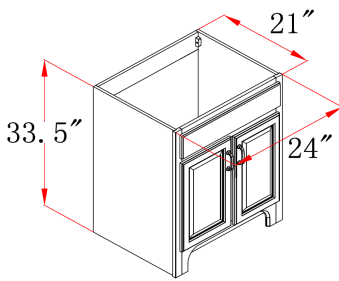

530386

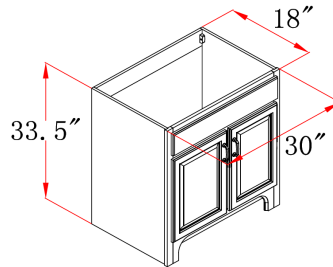

541144

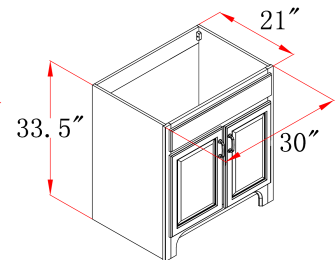

530394

## Warranty & Compliances

**Warranty** Limited 1 year warranty  
**California 93120** Compliant



## Order Codes & Finishes/Colors

24" w x 18" d x 33.5" h	541110
24" w x 21" d x 33.5" h	530386
30" w x 18" d x 33.5" h	541144
30" w x 21" d x 33.5" h	530394

Type:
Job:
Order Code:
Approvals:

Design House reserves the right to make changes in materials, specifications & models at any time. Design House also reserves the right to discontinue product without notice or obligation.